

Harriston Industries, Inc.

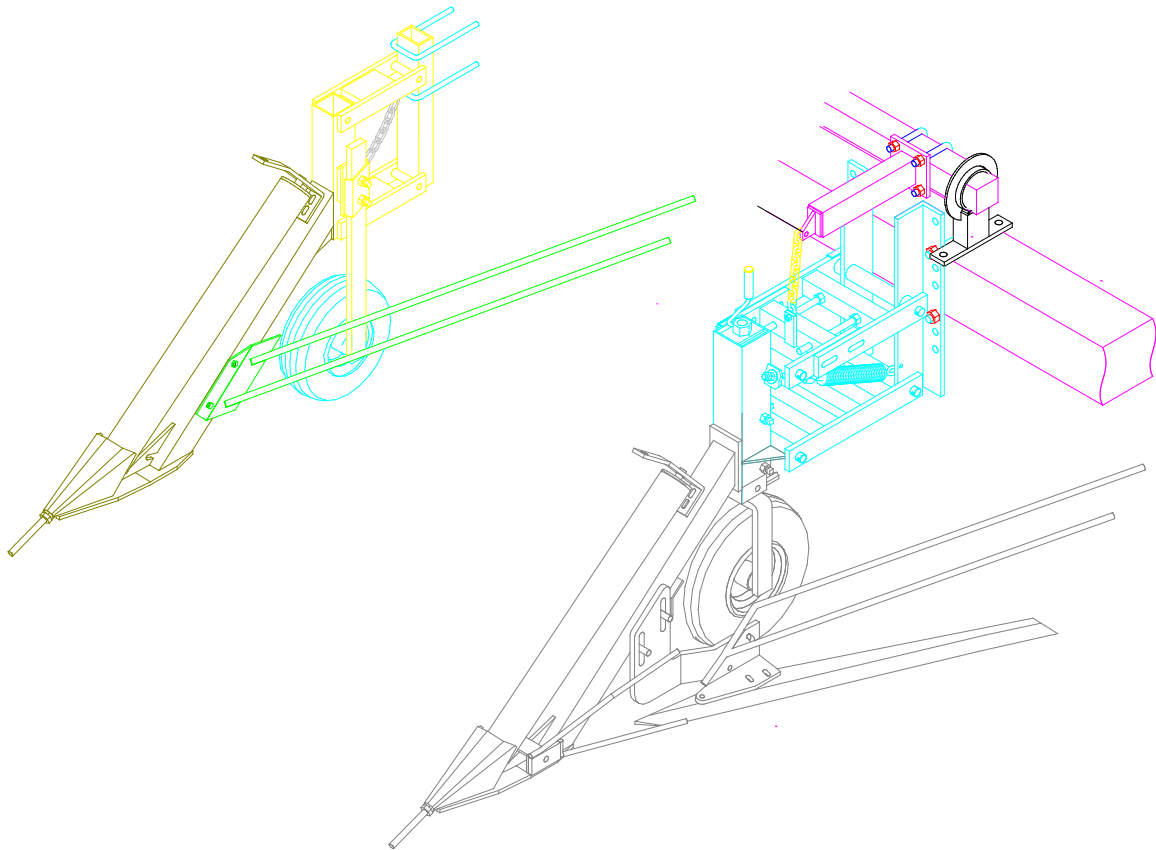

Bean Cutter & Stealth Cutter Operator's Manual

INTRODUCTION

Congratulations on your choice of a new Harriston Bean Cutter to complement your farming operation. This equipment has been designed and manufactured to meet the needs of a discerning Agricultural industry for the efficient cutting of beans.

Safe, efficient, and trouble free operation of your bean cutter requires that you and anyone else who will be operating or maintaining the machine, read and understand the Safety, Operation, and Trouble Shooting information contained within the Operator's Manual. Check each item referred to and acquaint yourself with the adjustments required to obtain efficient operation.

This manual covers all Bean Cutter models manufactured by Harriston. Differences are covered and explained where appropriate. Use the Table of Contents as a guide to locate required information.

Keep this manual handy for frequent reference and to pass on to new operators or owners. Call your Harriston Dealer or distributor if you need assistance, information, or additional copies of the manual.

The front section of this manual contains assembly, operation, and service instruction for the Bean Cutter. The rear section contains a complete list of parts available for service and repair.

OPERATOR ORIENTATION - The directions left, right, front, and rear, as mentioned throughout the manual, are as seen from the driver's seat and facing in the direction of travel.

TABLE OF CONTENTS

DESCRIPTION	PAGE NO.
TABLE OF CONTENTS.....	3
SAFETY.....	4
GENERAL SAFETY	5
OPERATING SAFETY	6
MAINTENANCE SAFETY	6
HYDRAULIC SAFETY.....	7
TRANSPORT SAFETY	7
TIRE SAFETY	8
SAFETY DECALS	8
SIGN OFF FORM.....	9
OPERATION AND SERVICE	10
TROUBLE SHOOTING	12
ASSEMBLY.....	13
MID MOUNT ASSEMBLY.....	14
REAR MOUNT ASSEMBLY	16
FRONT DIVIDER MOUNT	18
MIDMOUNT & TOOLBAR	19
#505000 MIDMOUNT ASSEMBLY.....	20
DIVIDER MOUNTING	21
BAR MOUNT ASSEMBLY.....	22
HD 1998 DIVIDER TRACTOR MOUNT ASSY.....	24
LINKAGE ASSEMBLIES	26
KNIFE SHANKS & GAUGE WHEELS.....	28
DOUBLE REAR LINKAGE ASSEMBLY	30
REAR MOUNT ASSEMBLIES.....	32
TRACTOR MOUNTS.....	33
STEALTH TROUBLESHOOTING	35
STEALTH UNIT TOOL BAR ASSEMBLIES	36
STEALTH CUTTING UNIT SHORT.....	38
STEALTH CUTTING UNIT LONG.....	40
GAUGE WHEEL ASSEMBLY.....	42
HYDRAULIC SCHEMATICS	44
1996 HEAVY DIVIDER 1 ST YEAR.....	48
STEALTH ASSEMBLY	49
STEALTH DIVIDER ASSEMBLY.....	50
FRONT LIFT PREVIOUS TO 1995	51
VARIOUS MOUNTINGS TO DIFFERENT MODELS OF TRACTORS....	52
PUSH CUTTER MOUNTING LINKAGE	60
PUSH CUTTER ROW LINKAGES	61
PUSH CUTTER ROW LINKAGES COMPLETE.....	62
TRACTOR MOUNTS.....	63
PUSH CUTTER ACCESSORY BREAKDOWN	64
DIVIDERS.....	65
INDEX	66

SAFETY

SAFETY ALERT SYMBOL

This Safety Alert symbol means
ATTENTION! BECOME ALERT!
YOUR SAFETY IS INVOLVED!

The Safety Alert symbol identifies important safety messages on the Harriston Bean Cutter and in the manual. When you see this symbol, be alert to the possibility of personal injury or death. Follow the instructions in the safety message.



Why is SAFETY important to you?

3 Big Reasons

Accidents Disable and Kill
Accidents Cost
Accidents Can Be Avoided

SIGNAL WORDS:

Note the use of the signal words **DANGER, WARNING, and CAUTION** With the safety messages. The appropriate signal word for each message has been selected using the following guide lines:

DANGER – An immediate and specific hazard which **WILL** result in severe personal injury or death if the proper precautions are not taken.

WARNING – A specific hazard or unsafe practice which **COULD** result in severe personal injury or death if proper precautions are not taken.

CAUTION – Unsafe practices which **COULD** result in personal injury if proper practices are not taken, or as a reminder of good safety practices.

YOU are responsible for the SAFE operation and maintenance of your Harriston Bean Cutter. **YOU** must ensure that you and anyone else who is going to operate, maintain, or work around the Bean Cutter be familiar with the operating and maintenance procedures and related SAFETY information contained in this manual. This manual will take you step-by-step through your working day and alerts you to all good safety practices that should be adhered to while operating the Bean Cutter.

Remember, **YOU** are the key to safety. Good safety practices not only protect you but also the people around you. Make these practices a working part of your safety program. Be certain that **EVERYONE** operating this equipment is familiar with the recommended operating and maintenance procedures and follows all the safety precautions. Most accidents can be prevented. Do not risk injury by ignoring good safety practices.

- Bean Cutter owners must give operating instructions to operators or employees before allowing them to operate the Bean Cutter, and at least annually thereafter per OSHA (Occupational Safety and Health Administration) regulation 1928.57.
- The most important safety device on this equipment is a SAFE operator. It is the operator's responsibility to read and understand ALL Safety and Operating instructions in the manual and to follow them. All accidents can be avoided.
- A person who has not read and understood all operating and safety instructions is not qualified to operate the machine. An untrained operator exposes himself and bystanders to possible serious injury or death.
- Do not modify the equipment in any way. Unauthorized modification may impair the function and/or safety and could affect the life of the equipment.
Think SAFETY! Work SAFELY!

GENERAL SAFETY

1. Read and understand the Operator's Manual and all safety signs before operating, maintaining, adjusting, or unplugging the Bean Cutter.



2. Have a first-aid kit available for use should the need arise, and know how to use it.

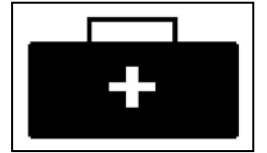

3. Have a fire extinguisher available for use should the need arise, and know how to use it.



4. Wear appropriate protective gear. This list includes, but is not limited to:

- ✓ A hard hat
- ✓ Protective shoes with slip resistant soles
- ✓ Protective glasses or goggles
- ✓ Heavy gloves
- ✓ Wet weather gear
- ✓ Hearing protection



5. Install and secure all guards before starting.

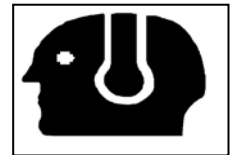

6. Do not allow riders.

7. Wear suitable ear protection for prolonged exposure to excessive noise.

8. Lower machine to the ground, place all controls in neutral, stop tractor engine, set park brake, remove ignition key, and wait for all moving parts to stop before servicing, adjusting, repairing, or unplugging.

9. Clear the area of people, especially small children, before starting the unit.

10. Review safety related items annually with all personnel who will be operating or maintaining the Bean Cutter .

OPERATING SAFETY

Bookmark not defined.

1. Read and understand the Operator's Manual and all safety signs before operating, servicing, adjusting, repairing, or unplugging.
2. Do not allow riders.
3. Install and secure all guards and shields before starting or operating.
4. Keep hands, feet, hair, and clothing away from moving parts.
5. Lower machine to the ground, place all controls in neutral, stop tractor engine, set park brake, remove ignition key, and wait for all moving parts to stop before servicing, adjusting, repairing, or unplugging.
6. Place all tractor and machine controls in neutral before starting.
7. Clear the area of bystanders, especially small children, before starting.
8. Stay away from machine when raising or lowering wings. Keep others away.
9. Keep all hydraulic lines, fittings, and couplers tight and free of leaks before using.
10. Clean reflectors and lights before transporting.
11. Use hazard flashers on tractor when transporting.
12. Stay away from overhead electrical wires.
13. Review safety instructions with all operators annually.

MAINTENANCE SAFETY

1. Follow ALL the operating, maintenance, and safety information in the manual.
2. Support the machine with blocks or safety stands when changing tires or working beneath it.
3. Follow good shop practices:
 - Keep service area clean and dry.
 - Be sure electrical outlets and tools are properly grounded.
 - Use adequate light for the job at hand.
4. Use only tools, jacks, and hoists of sufficient capacity for the job.
5. Lower machine to the ground, place all controls in neutral, stop tractor engine, set park brake, remove ignition key, and wait for all moving parts to stop before servicing, adjusting, repairing, or unplugging.
6. Make sure all guards are in place and properly secured when maintenance work is completed.
7. Before applying pressure to a hydraulic system, make sure all lines, fittings, and couplers are tight and in good condition.
8. Relieve pressure from hydraulic circuit before servicing or disconnecting from tractor.
9. Keep hands, feet, hair, and clothing away from moving or rotating parts.
10. Clear the area of bystanders, especially small children, when carrying out any maintenance and repairs or making any adjustments.

HYDRAULIC SAFETY

1. Make sure that all components in the hydraulic system are kept in good condition and are clean.
2. Replace any worn, cut, abraded, flattened, or crimped hoses and metal lines.
3. Relieve pressure before working on hydraulic system.
4. Do not attempt any makeshift repairs to the hydraulic lines, fittings, or hoses by using tape, clamps, or cements. The hydraulic system operates under extremely high-pressure. Such repairs will fail suddenly and create a hazardous and unsafe condition.

5. Wear proper and eye protection searching for high-pressure hydraulic leak. Use a piece of wood or cardboard as backstop of hands to isolate and identify a leak.



hand
when
a
Use a
or
a
instead

6. If injured by a concentrated high-pressure stream of hydraulic fluid, seek medical attention immediately. Serious infection or toxic reaction can develop from hydraulic fluid piercing the skin surface.
 7. Before applying pressure to the system, make sure all components are tight and that lines, hoses, and couplings are not damaged.
- Think SAFETY! Work SAFELY

TRANSPORT SAFETY

1. Make sure you are in compliance with all local regulations regarding transporting equipment on public roads and highways.
2. Make sure the SMV (Slow Moving Vehicle) emblem and all the lights and reflectors that are required by the local highway and transport authorities are in place, are clean, and can be seen clearly by all overtaking and oncoming traffic.
3. Do not allow anyone to ride on the Bean Cutter or tractor during transport.
4. Do not exceed 32 km/h (20 mph). Reduce speed on rough roads and surfaces.
5. Always use hazard flashers on the tractor when transporting unless prohibited by law.

STORAGE SAFETY

1. Store the unit in an area away from human activity.
2. Do not permit children to play on or around the stored machine.
3. Store the unit in a dry, level area. Support the base with planks if required.

TIRE SAFETY

1. Failure to follow proper procedures when mounting a tire on a wheel or rim can produce an explosion which may result in serious injury or death.
2. Do not attempt to mount a tire unless you have the proper equipment and experience to do the job.
3. Have a qualified tire dealer or repair service perform required tire maintenance.

SAFETY DECALS

1. Keep safety decals and signs clean and legible at all times.
2. Replace safety decals and signs that are missing or have become illegible.
3. Replaced parts that displayed a safety sign should also display the current sign.
4. Safety decals or signs are available from your Dealer Parts Department or the factory.

How to Install Safety Decals:

- Be sure that the installation area is clean and dry.
- Decide on the exact position before you remove the backing paper.
- Remove the smallest portion of the split backing paper.
- Align the decal over the specified area and carefully press the small portion with the exposed sticky backing in place.
- Slowly peel back the remaining paper and carefully smooth the remaining portion of the decal in place.
- Small air pockets can be pierced with a pin and smoothed out using the piece of decal backing paper.

OPERATION AND SERVICE

Adjustment of Bean Cutter prior to field operation:

Midmount Adjustment

The rear 4" x 4" Tool Bar (1) should be 90° to the ground surface. This adjustment is done by turning the adjustment screws (2) on top of the Rear Midmount Frame.

Blade/Gauge Wheel Setting

After mounting cutter on tractor, position the tractor on a level concrete floor. Raise gauge wheels (3) up & tighten set screws enough to hold wheels up temporarily. Loosen bolts that hold blade shoe to shank (4), then place a 3/4" block (5) under the blades (6) as shown. Lower cutter completely. Blades should settle into place as shown. Double-check position of blades as the shoe bolts are tightened firmly. Loosen gauge wheel set screws & adjust wheels so they touch the floor. This is your initial setting, in-field gauge wheel adjustments may be required.

Double-check the measurement from the bean row to the center of the Each row should measure 7" (fig. 1-3) . Adjust position of cutting units if

In dry soil conditions and moderately hilly land, install all three bolts in keep in line.

In wet soil conditions, remove the rear bolt and straighten blade so less carried on the blade.

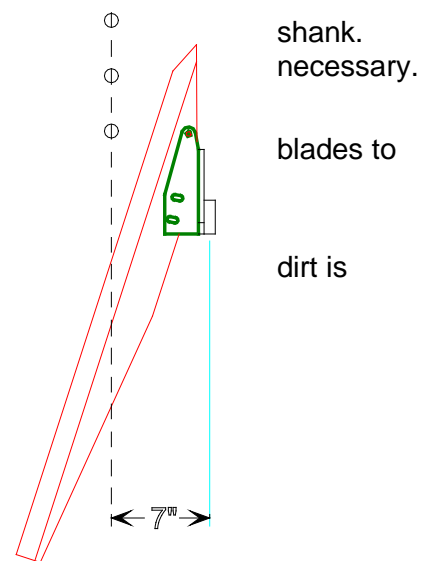

Blade & Row Spacing

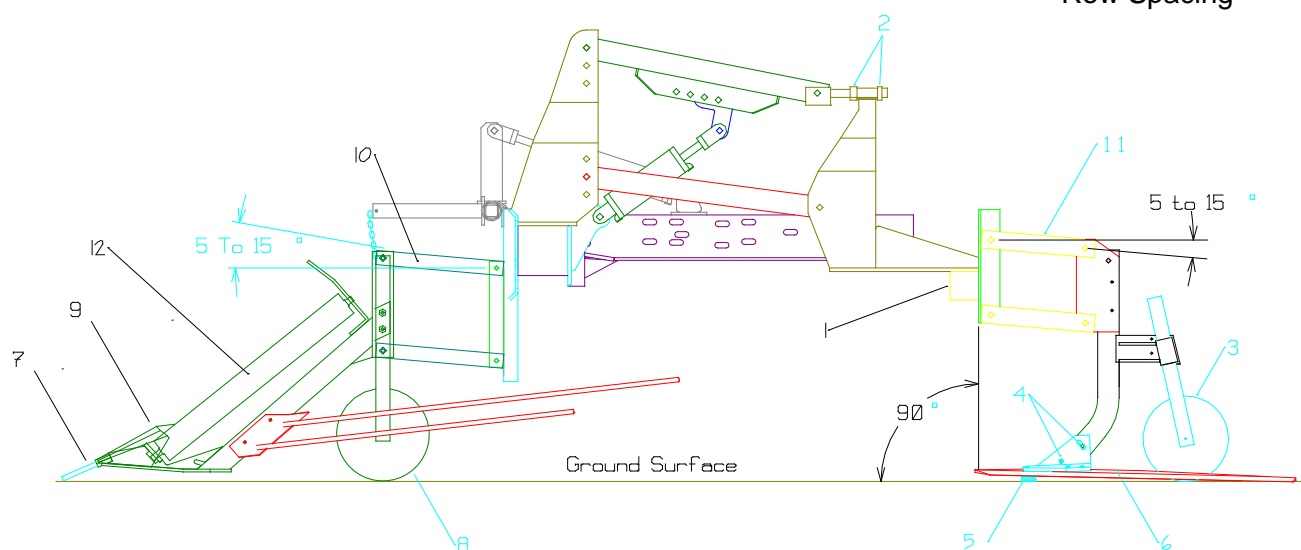

In hilly terrain, or if you are covering beans with dirt, move the cutting unit away from the row. Position shank 8" from row instead of 7".

Divider Rod Adjustment

Fig. 1-4 Bean cutter shoe rods should be adjusted so the bottom rod is flush with the back end of the cutting edge on the blade. The top rod should be out slightly more than the bottom rod. All should be bent to allow beans to flow through evenly. Bending ends of the rods straight as shown at right will usually allow for flow.

Row Divider Setting Adjustment

For conditions where there are vines lying on the ground, set divider point rod so it will be just below the ground surface. If there are no vines on the ground, the divider point rod may be set above the ground surface.

On rear mount cutters, it is necessary to adjust the top 3 Point link to keep the bottom of the divider shoe running level. This adjustment should be done prior to adjusting the tilt of the blades.

Divider Gauge Wheels

Adjust Divider Gauge Wheel (8) position to hold the bottom surface of divider shoe approx. 3/4" off the ground when in the operating position.

Parallel Linkage

The parallel linkage on both the dividers (10) and the cutting units (11) should run at a 5 to 15° angle (higher in the front) when working to prevent "nose-diving".

Divider Rollers

The divider rollers (12) must turn freely or vine bunching will result. Periodically clean dirt out of shoes and lubricate both ends of roller shaft with a few drops of thin oil.

Lubrication

Grease all fittings as follows;

Divider Wheels – Daily

Midmount Linkage – Daily

Cutting Units - Daily

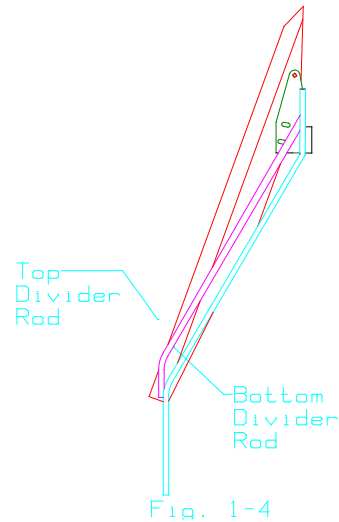

blade.
rods
the
better

the
there
above

TROUBLESHOOTING

PROBLEM	CAUSE	SOLUTION
Pushing too much dirt	<p>Blade too deep</p> <p>Blade at too much of an angle Shank too close to row</p> <p>Blades dull Tilt of blade may be off</p>	<p>Adjust gauge wheel to make blade run shallower</p> <p>Loosen blade bolts & straighten blade Measure cutter shank (See Blade setting on Page 11) Move shank to 8" away from row if necessary</p> <p>Sharpen or replace blades Reset Front of blade (See Blade setting on Page 14)</p>
Leaving too many beans	<p>Blade too shallow</p> <p>Blade not at enough angle</p> <p>Distance from shank to row is not correct</p> <p>Blades dull Tilt of blade may be off</p>	<p>Adjust gauge wheel to make blade run deeper</p> <p>Loosen blade bolts and move heel of blade out</p> <p>Measure cutter shank (See Blade setting on Page 11)</p> <p>Sharpen or replace blades Reset Front of blade (See Blade setting on Page 14)</p>
Blade Shanks Nose Diving	<p>Rear 4 x 4 Toolbar not adjusted properly</p> <p>Bent or damaged Linkage parts</p>	<p>Adjust according to instructions on page 14</p> <p>Straighten or Replace</p>
Divider Plowing	<p>Divider Shoe set to run too deep</p> <p>Point rod too Deep</p> <p>Linkage not mounted properly (Rear too high)</p> <p>Parallel Linkage & or Divider Mount Tubes bent</p>	<p>Adjust Divider Gauge Wheel to hold Bottom of Divider Shoe 3/4" off ground</p> <p>Adjust Point Rod so it barely enters soil</p> <p>Loosen bolts and adjust linkage (See Parallel Linkage on Page 14)</p> <p>Straighten or Replace</p>
Vines Plugging on Dividers and/or Blade Shanks	<p>Lodged Vines/White Mold</p> <p>Divider Rollers don't turn freely</p>	<p>Be sure Divider Point Rod is set so it is below the ground surface at all times.</p> <p>Increase speed</p> <p>Move Shanks further away from row</p> <p>Lubricate/Clean Roller shafts so Rollers turn freely</p>
Shelling Out Beans	<p>Beans too dry</p>	<p>Cut when there is a dew</p> <p>Move Blade Shank further away from rows to disturb beans less.</p> <p>Straighten Divider Rods to disturb beans less.</p> <p>Slow Down</p>

ASSEMBLY

SIDE MOUNT INSTALLATION

The side plate mounts attach to the side of your tractor. Tire size, type of cutter, weight brackets, make & model all affect how the side mounts are put on. Due to these factors the side mounts may not fit all tractors-some modification and or spacers may be needed. Refer to the following diagrams shown to mount side plates to your tractor. Included at the back of the book are some tractors with various mounts. Always check The tire clearance to the toolbar and knives when mounting tool bar and side mounts.

Note: the 7000 & 8000 series require special mounts available by order only. These mounts are not provided unless ordered.

IHC 86 Series & Older -

Mount front plate 8" to 10" from front of tractor.

IHC 50 Series -

Mount adapter plate to tractor and attach side plates to tractor and plates.

Case -

Attach side mount plate to tractor, positioning so divider mount tube is 2" to 4" from front of tire (2" preferred). Some models will require removal of muffler and the battery case.

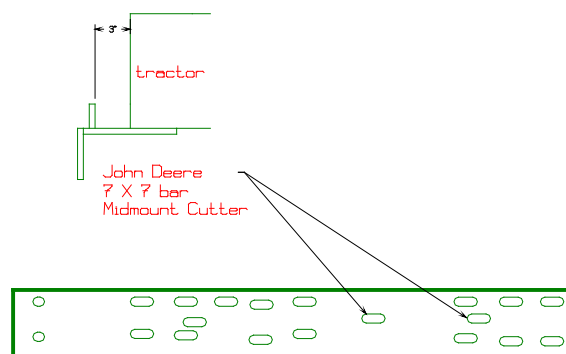
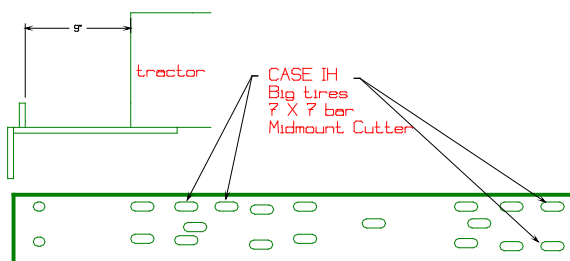
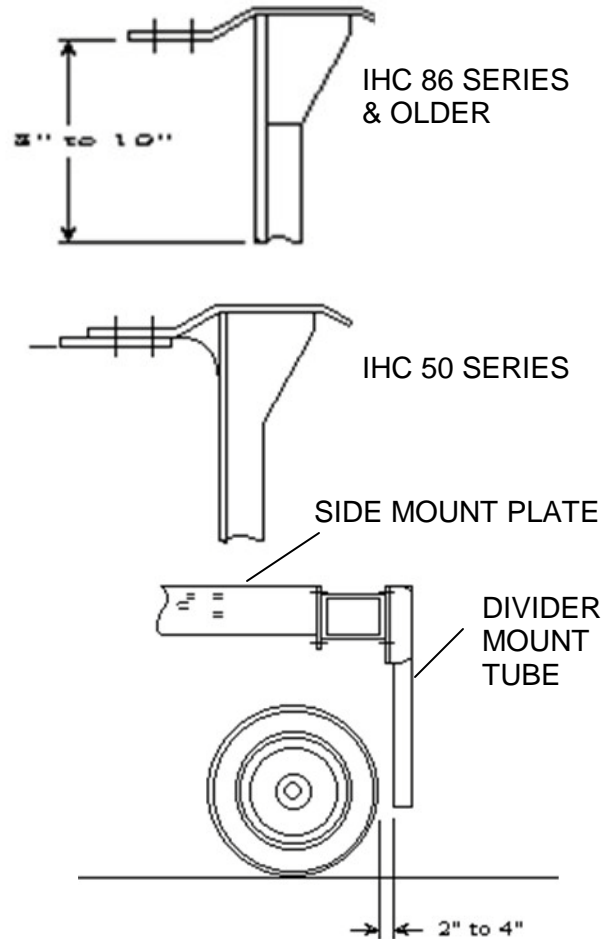

MID MOUNT ASSEMBLY

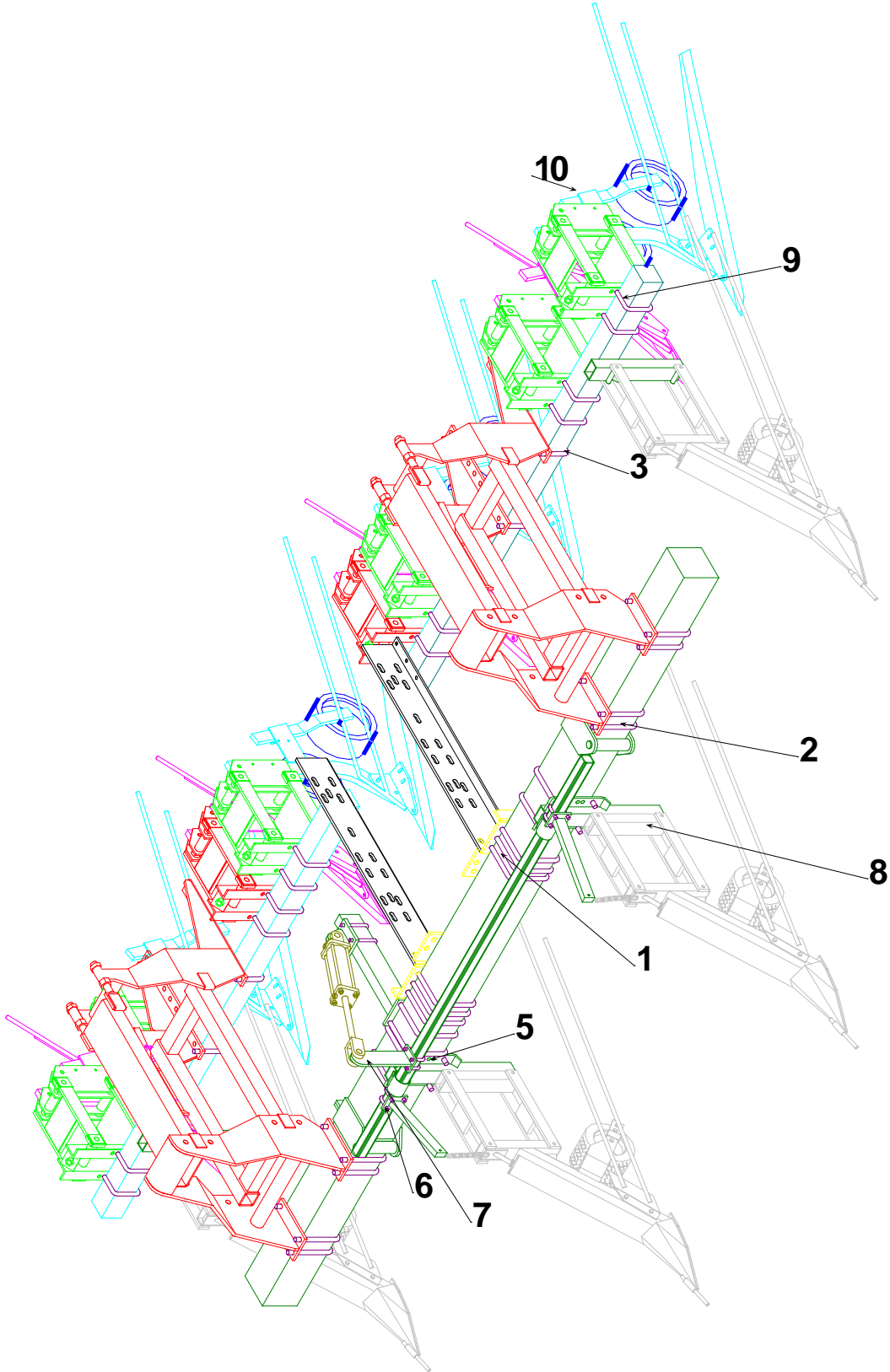

MID MOUNT ASSEMBLY

1. Attach the tractor mounts to the tractor. Make sure tool bar clears tires when turning.
2. Center tool bar to the side mounts and attach with u-bolts.
3. Assemble the midmount linkage to the tool bar with u-bolts. Refer to rear of this manual for positioning.
4. Assemble the 4" x 4" bar to the rear of the midmount linkage with u-bolts. Refer to the rear of the manual for your row spacing.
5. Place the upper cylinder ear in the hole desired in the upper midmount linkage. Assemble the cylinder mount on the tool bar, centering in line with the upper cylinder ear. On 6 row 22" spacing a straight bolts are used through the cylinder mount and the divider mount tube.
6. Assemble divider mount tubes on front tool bar. Center the tubes between rows. On 12-22" spacing, divider mount tubes are mounted on separate tool bar offset from the main tool bar. Assemble pivot pipe mount on the divider mount tubes with clevis pins.
7. Slide the lift tube into the pivot pipe mounts. Center the lift tube and attach divider lift tubes.
8. Assemble the cylinder mount bracket to the 7 x 7 tool bar next to the tractor mounts.
9. Assemble the cylinder lift arm to the 2" x 2" lift tube in line with the cylinder mount bracket. With the lift arms horizontal install the cylinder and the ear weldment.
10. Attach row dividers to the divider mount tubes with u-bolts and backing plates. Attach chain to lift arms with clevis pin.
11. Assemble linkage/cutting unit to 4" x 4" with u-bolts. Align so row shank is 7" off the row. Refer to fig. 1-2 at bottom of page.
12. Install row shank in linkage. The 5/16" shear bolt can be placed in either hole, depending on how easily the operator wants the bolt to shear. Row shanks next to or under tractor use two 5/16" shear bolts to prevent shank from tripping and damaging the tractor.

Fig 1-2

22" – 5" and 39"
 30" – 16" and 44"
 36" – 22" and 50"
 38" – 24" and 52"

Note: common row
 Spacings are in back of
 book

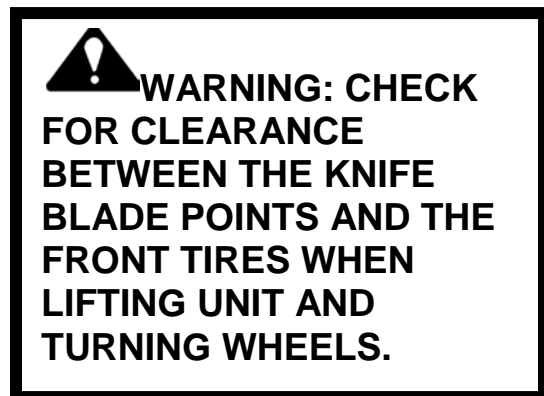
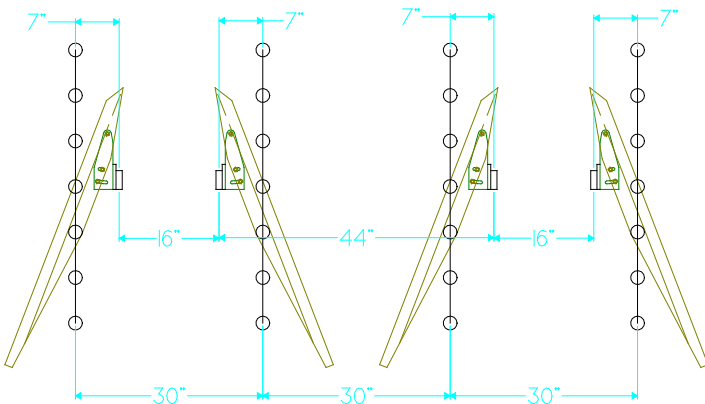

REAR MOUNT ASSEMBLY

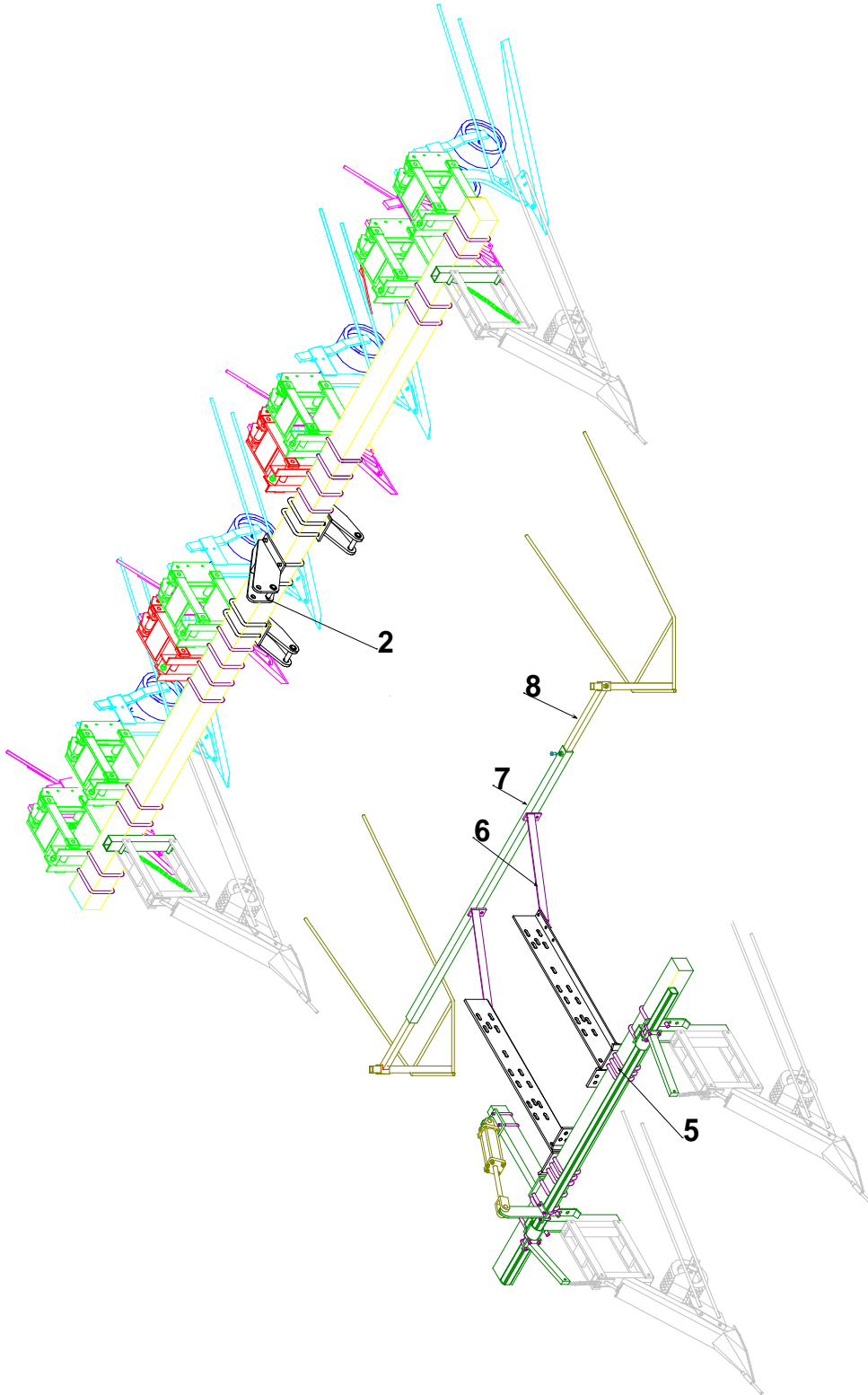

REAR MOUNT ASSEMBLY

1. Find and mark off the center of the tool bar. Mark the row spacing on both sides of the center. For example, for 30" spacing mark 15" on each side of center and then in 30" increments.
2. Assemble the top 3-pt on center of tool bar. Attach the lower 3-pt, space the lower 3-pt ears 32" apart. (See drawing below)
3. Attach the row dividers and cutting units in the same manner as the mid mount cutter. Assembly so center of shank is 7" off the row.
4. Assemble the tractor mounts in the same manner as a midmount. Refer to mid mount instructions.
5. Attach the rear mounting bracket to the holes in the tractor mounts as shown.
6. Attach the rear cross tube to the rear mounting brackets. Slide the rear row divider mounting tube into the rear cross tube. Adjust to center on the rear tractor tire. Slide the rear row divider into the divider mounting tube. Set the divider approximately 2" above the ground.
7. The divider system in front of the tractor is similar to a mid mount. The 7" x 7" tool bar is replaced by a 4" X 4" tool bar.

Note: If possible, do not use a quick hitch attachment. If the contact points on the quick hitch attachment are loose, the machine can rock back and forth. This action will change the cutting angle on the blades, and will have trouble cutting the beans. If it is necessary to use a quick hitch make sure all six points are bushed tightly.

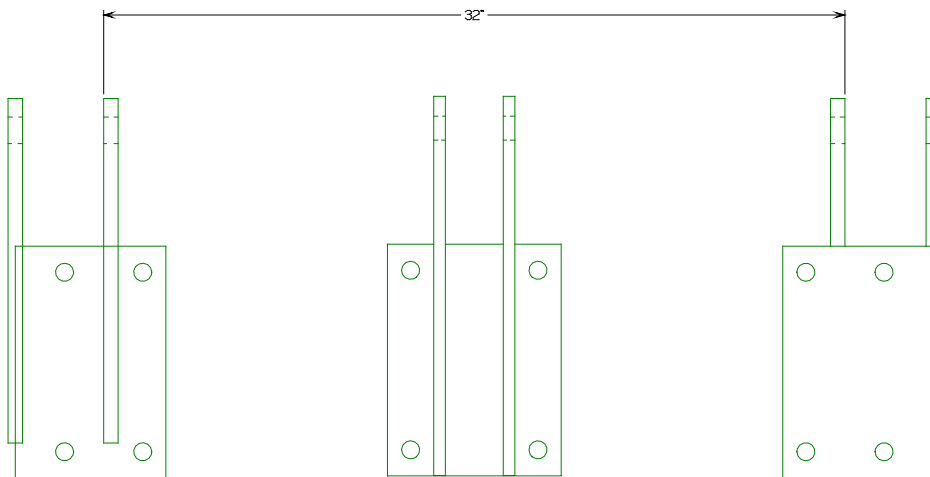

FRONT DIVIDER LIFT

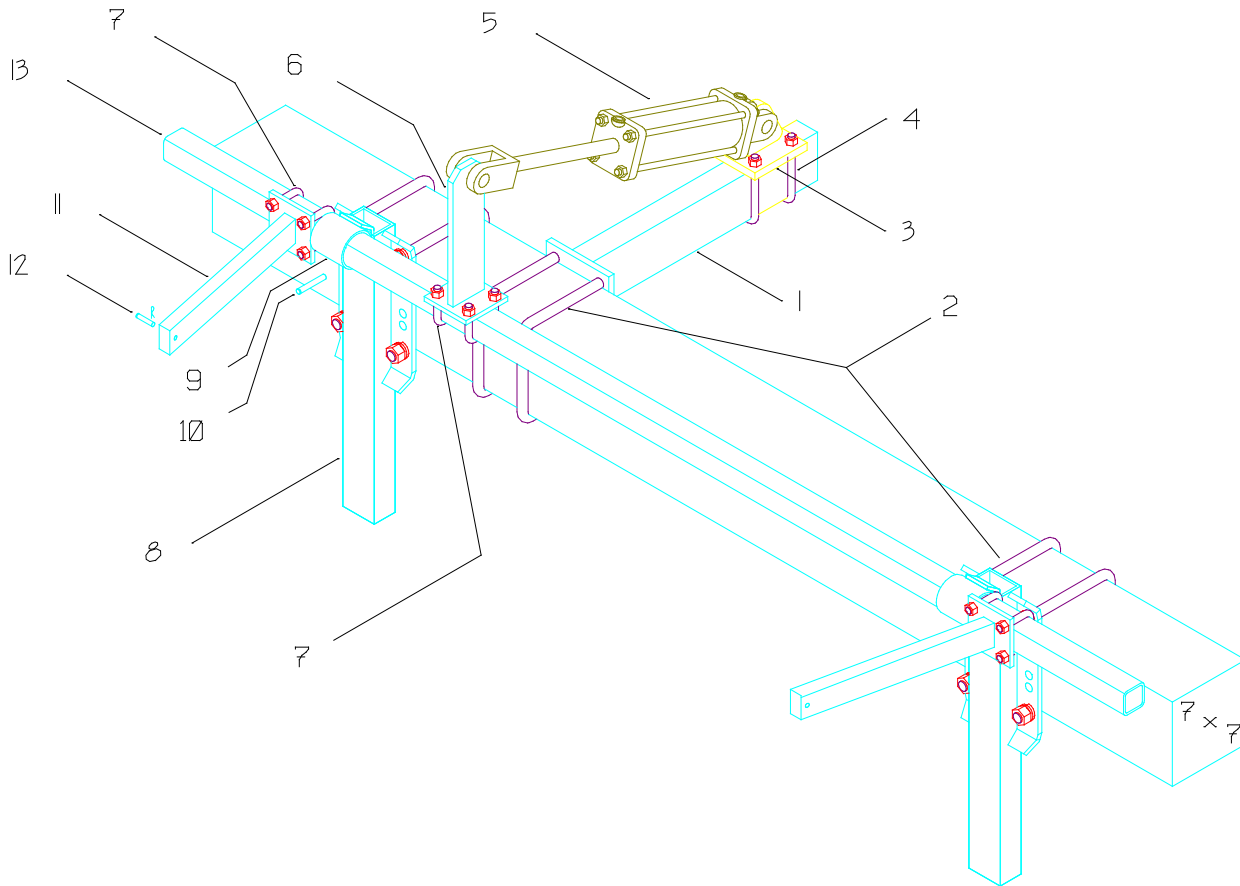

REF.	PART NO.	DESCRIPTION
1	505760	Cylinder Mount Bracket
2	021036	5/8" x 7" x 8 1/2" U-Bolt
	020506	5/8" Lock Washer
	020406	5/8" Nut
3	505770	Divider Cylinder Mount Weldment
4	021001	1/2" x 2" x 5 1/4" U-Bolt
	020504	1/2" Lock Washer
	020404	1/2" Nut
5	095172	3" x 8" 3/4 ORB Port Cylinder
6	504310	Cylinder Lift Arm
7	021000	1/2" x 2" x 3" U-Bolt
8	504100	Divider Mount Tube
9	504210	Pivot Pipe Weldment (95)
10	020875	3/8" x 2 1/2" Clevis Pin
11	504410	Divider Lift Arm (95)
12	020865	5/16" x 1 1/2" Clevis Pin
13	504010	Divider Lift Tube (95)

MIDMOUNT & TOOLBAR

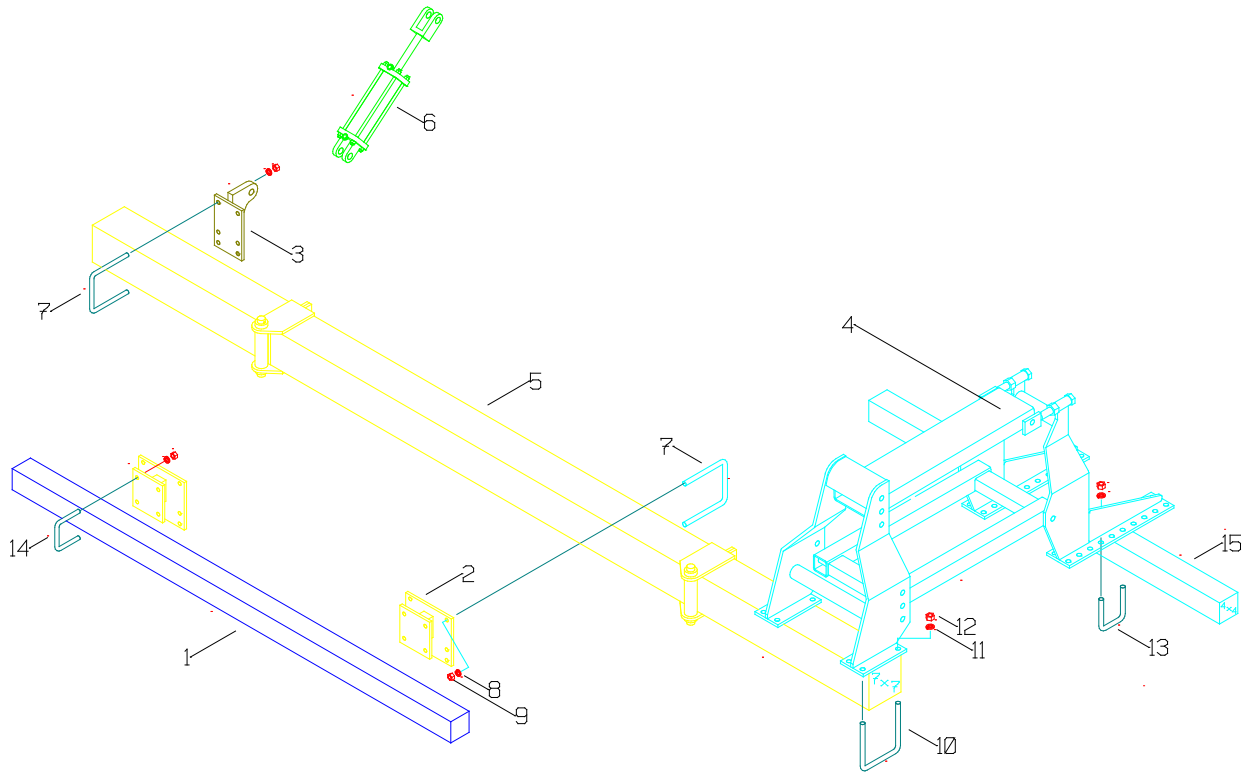

REF.	PART NO.	DESCRIPTION
1	506570	4" x 4" Tool Bar 96" (22" Rows Only)
2	506330	12-22 Offset (22" Rows Only)
3	505700	Cylinder Mount
4	505000	Midmount Linkage Frame Assembly
5	506680	Midmount Toolbar 7" x 7"
	506670	Midmount Toolbar 5" x 7"(96" Center Frame Length)
	506600	Midmount Toolbar 22" (50" Center Frame Length)
6	095172	3" x 8" Hydraulic Cylinder
7	021036	5/8" x 7" x 8 1/2" U-Bolt
8	020506	5/8" Lock Washer
9	020406	5/8" Nut
10	021037	3/4" x 7" x 8 1/2" U-Bolt
11	020507	3/4" Lock washer
12	020407	3/4" Nut
13	021014	3/4" x 4" x 5 1/2" U-Bolt
14	021009	5/8" x 4" x 5 1/2" U-Bolt
15	506540	4" x 4" Toolbar 74"
	506500	4" x 4" Toolbar 43"
	506570	4" x 4" Toolbar 96"

#505000 MIDMOUNT ASSEMBLY

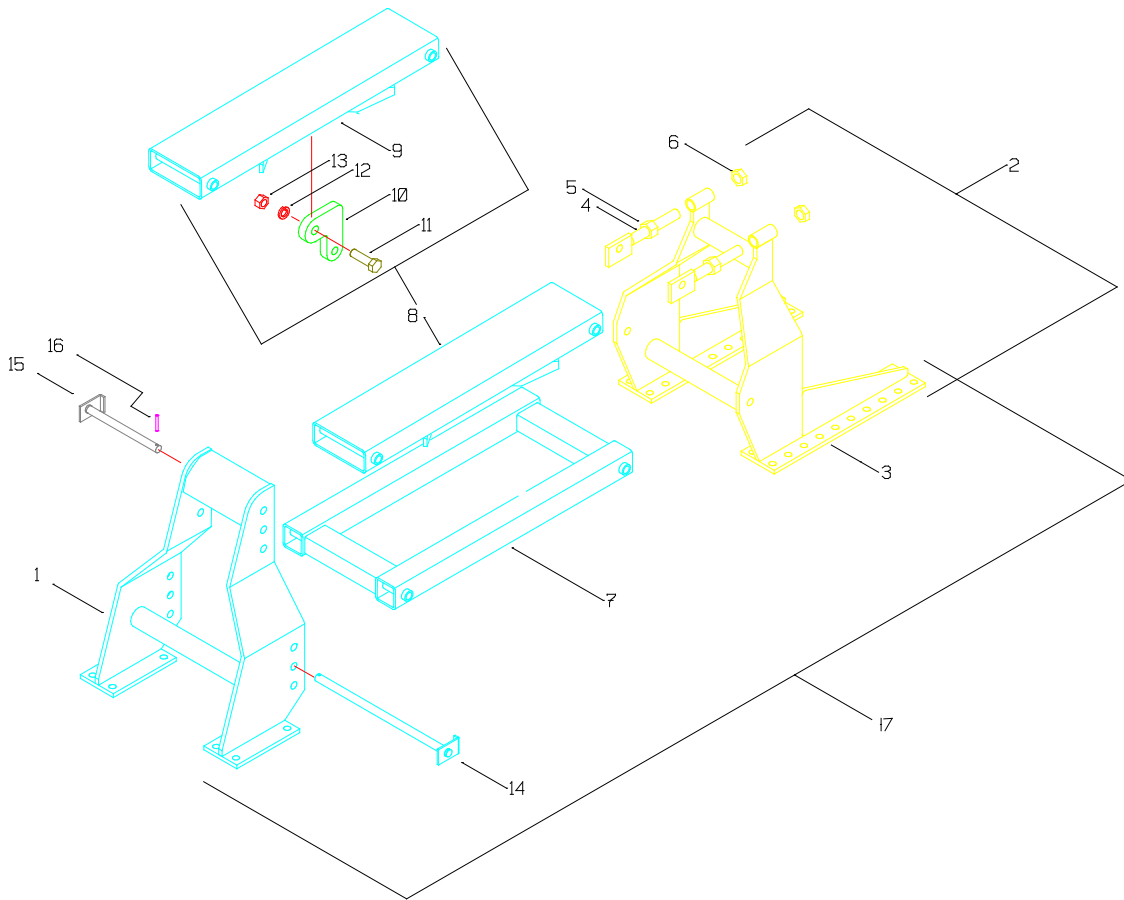

REF.	PART NO.	DESCRIPTION
1	505100	Midmount Front
2	508000	Midmount Back With Tilt Adjuster
3	505200	Midmount Back
4	505600	Tilt Adjuster
5	020410	1 1/8" Nut
6	020450	1 1/8" Jam Nut
7	505400	Midmount Lower Linkage
8	508100	Top Linkage With Cylinder Mount
9	505500	Midmount Top Linkage
10	505300	Midmount Lift
11	020096	7/8" x 3" Bolt
12	020508	7/8" Lock Washer
13	020408	7/8" Nut
14	505900	Midmount Bottom Pin
15	505800	Midmount Top Pin
16	020965	1/4" x 1 1/2" Spring Lock Pin
17	505000	Midmount Frame Assembly

DIVIDER MOUNTINGS

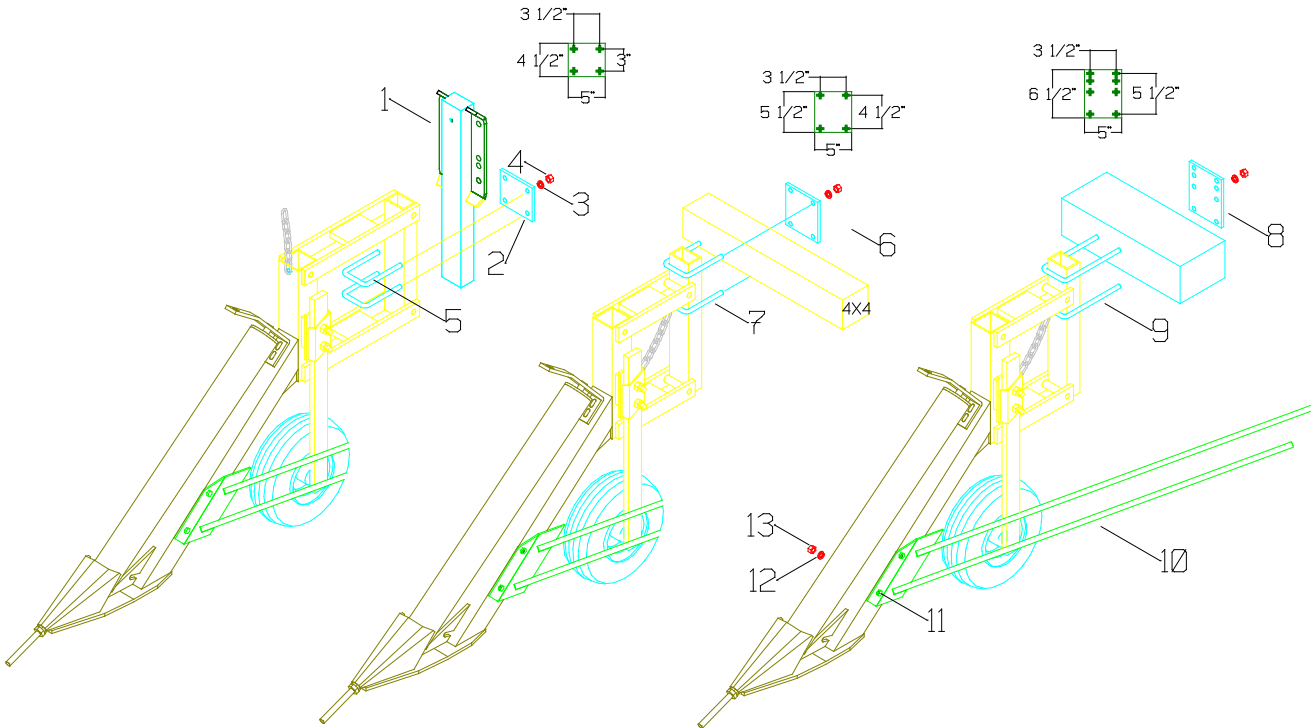

REF.	PART NO.	DESCRIPTION
1	504100	Divider Mount Tube
2	503800	Plate (Midmount)
3	020504	1/2" Lock Washer
4	020404	1/2" Nut
5	021003	1/2" x 3" x 5 1/4" U-Bolt
6	503830	Bar Divider Mount Plate
7	021004	1/2" x 3" x 7 1/4" U-Bolt
8	503700	Universal Bar Mount Plate
9	021006	1/2" x 3" x 10 1/4" U-Bolt
10	502000	Divider Rod Left
	501900	Divider Rod Right
11	020034	3/8" x 4" Bolt
12	020502	3/8" Lock Washer
13	020402	3/8" Nut

#510860 HD 1998 BAR MOUNT ASSEMBLY

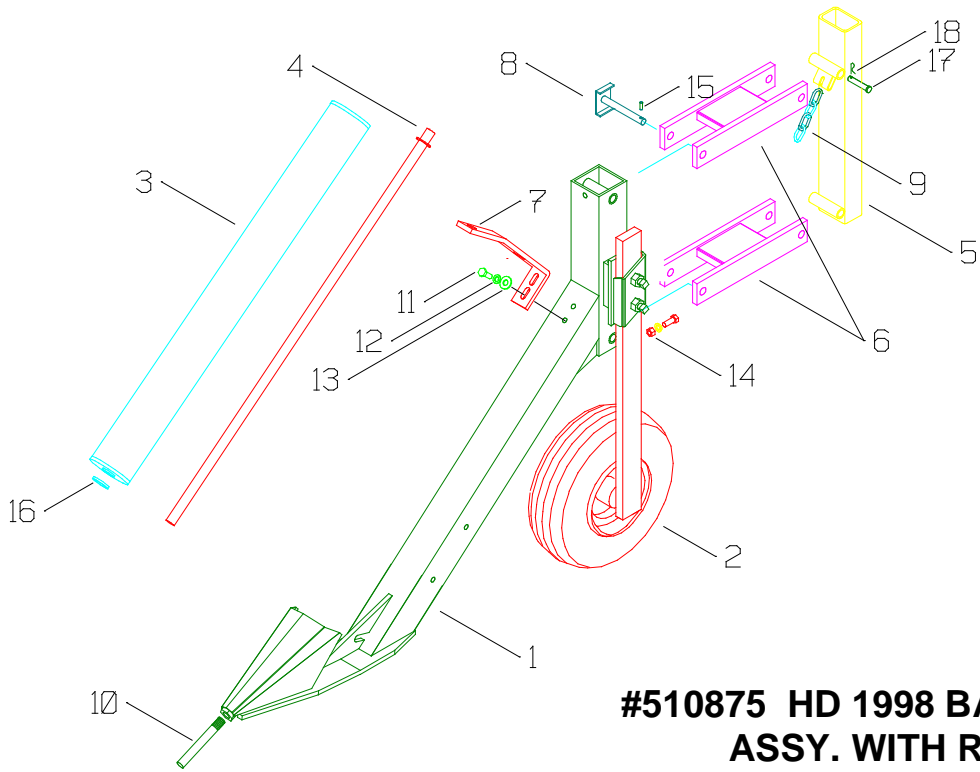

#510875 HD 1998 BAR MOUNT ASSY. WITH RODS

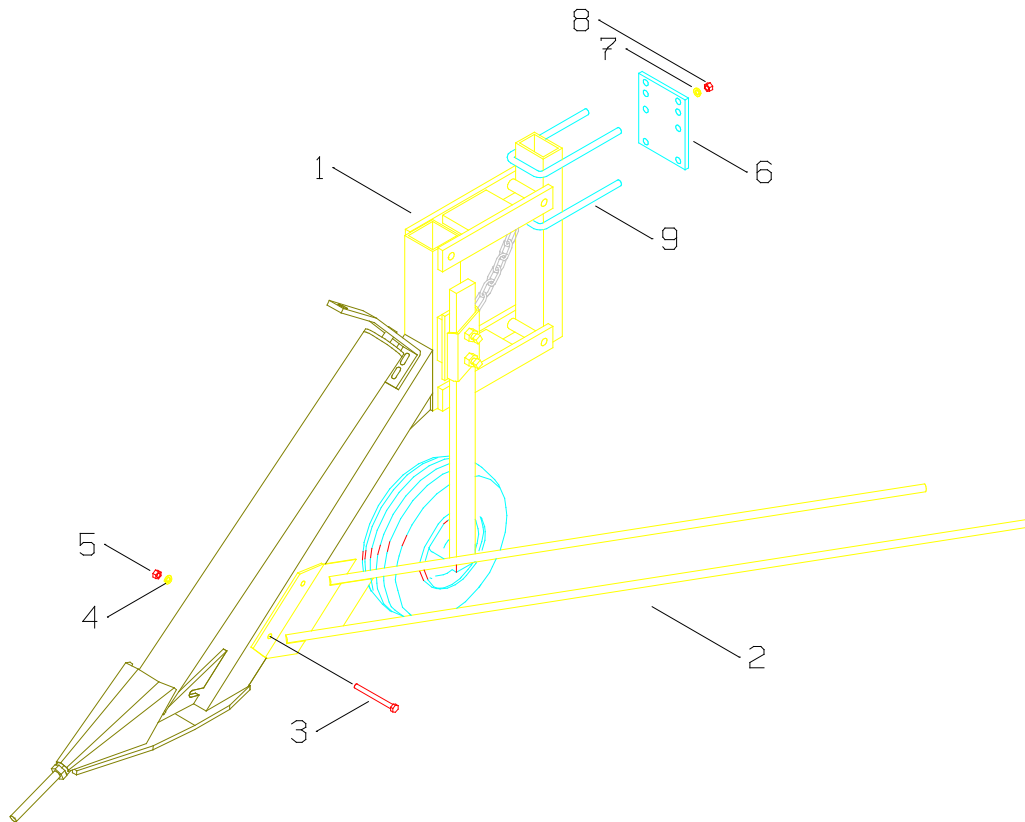

REF.	PART NO.	DESCRIPTION
1	510370	Divider Weldment 1998
2	510425	Divider Gauge Wheel Assembly 1996
3	510430	32 5/8" Roller Assembly
4	510540	36" Roller Shaft (3/4" CR) 1998
5	510395	Back Bar Tube 18" Long
6	510390	Divider Linkage 12" (1996)
7	510525	Upper Roller Mount 1998
8	510400	Row Divider Pin (1996)
9	502800	Divider Chain
10	510146	Divider Point Bolt
11	020029	3/8" x 1" Bolt
12	020502	3/8" Lock Washer
13	020513	3/8" Flat Washer
14	020402	3/8" Nut
15	020958	3/16" x 1 1/4" spring lock pin
16	021313	3/4" narrow 14 ga bushing
17	020860	1/4" x 2" Clevis Pin
18	020911	#2 Bridge Pin

REF.	PART NO.	DESCRIPTION
1	510860	HD 1998 Bar Mount Assy. with Rods
2	502000	Divider Rod Left
	501900	Divider Rod Right
3	020034	3/8" x 4" Bolt
4	020502	3/8" Lock Washer
5	020402	3/8" Nut
6	503700	Universal Bar Mount Plate
7	020504	1/2" Lock Washer
8	020404	1/2" Nut
9	021004	1/2" x 3" x 7 1/4" ubolt
	021003	1/2" x 3" x 5 1/4" ubolt
	021006	1/2" x 3" x 10 1/4" ubolt

#510865 HD 1998 DIVIDER TRACTOR MOUNT ASSY.

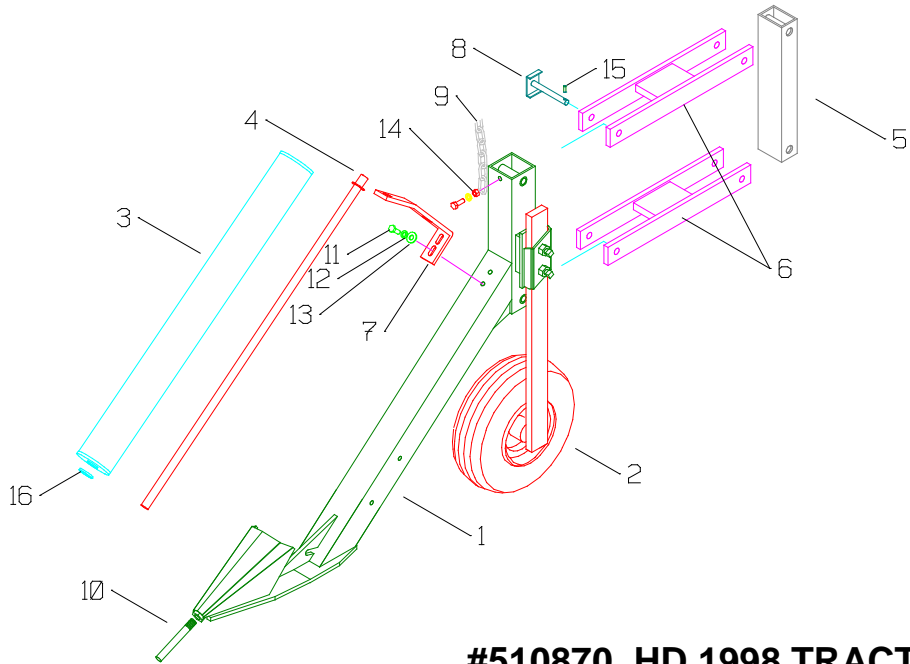

#510870 HD 1998 TRACTOR MOUNT ASSY. WITH RODS

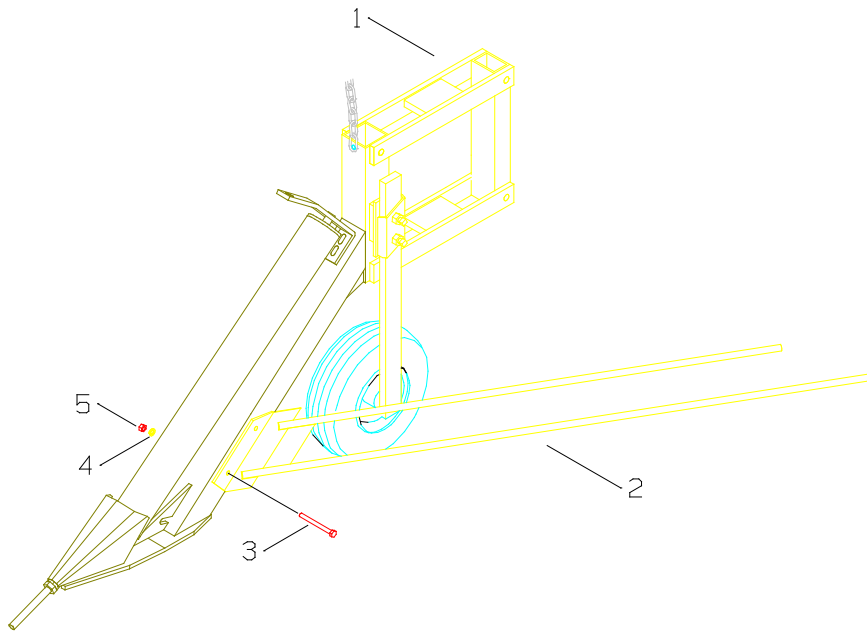

REF. PART NO. DESCRIPTION

1	510370	Divider Weldment 1998
2	510425	Divider Gauge Wheel Assembly 1996
3	510430	32 5/8" Roller Assembly
4	510540	36" Roller Shaft (3/4" CR) 1998
5	510440	Front Bar Tube Weldment 15" long
6	510445	Divider Linkage 18" (1996)
7	510525	Upper Roller Mount 1998
8	510400	Row Divider Pin (1996)
9	502800	Divider Chain
10	510146	Divider Point Bolt
11	020029	3/8" x 1" Bolt
12	020502	3/8" Lock Washer
13	020513	3/8" Flat Washer
14	020402	3/8" Nut
15	020958	3/16" x 1 1/4" spring lock pin
16	021313	3/4" narrow 14 ga bushing

REF. PART NO. DESCRIPTION

1	510860	HD 1998 Bar Mount Assy. with Rods
2	502000	Divider Rod Left
	501900	Divider Rod Right
3	020034	3/8" x 4" Bolt
4	020502	3/8" Lock Washer
5	020402	3/8" Nut

#500900 LINKAGE ASSEMBLY & #501000 LINKAGE ASSEMBLY COMPLETE

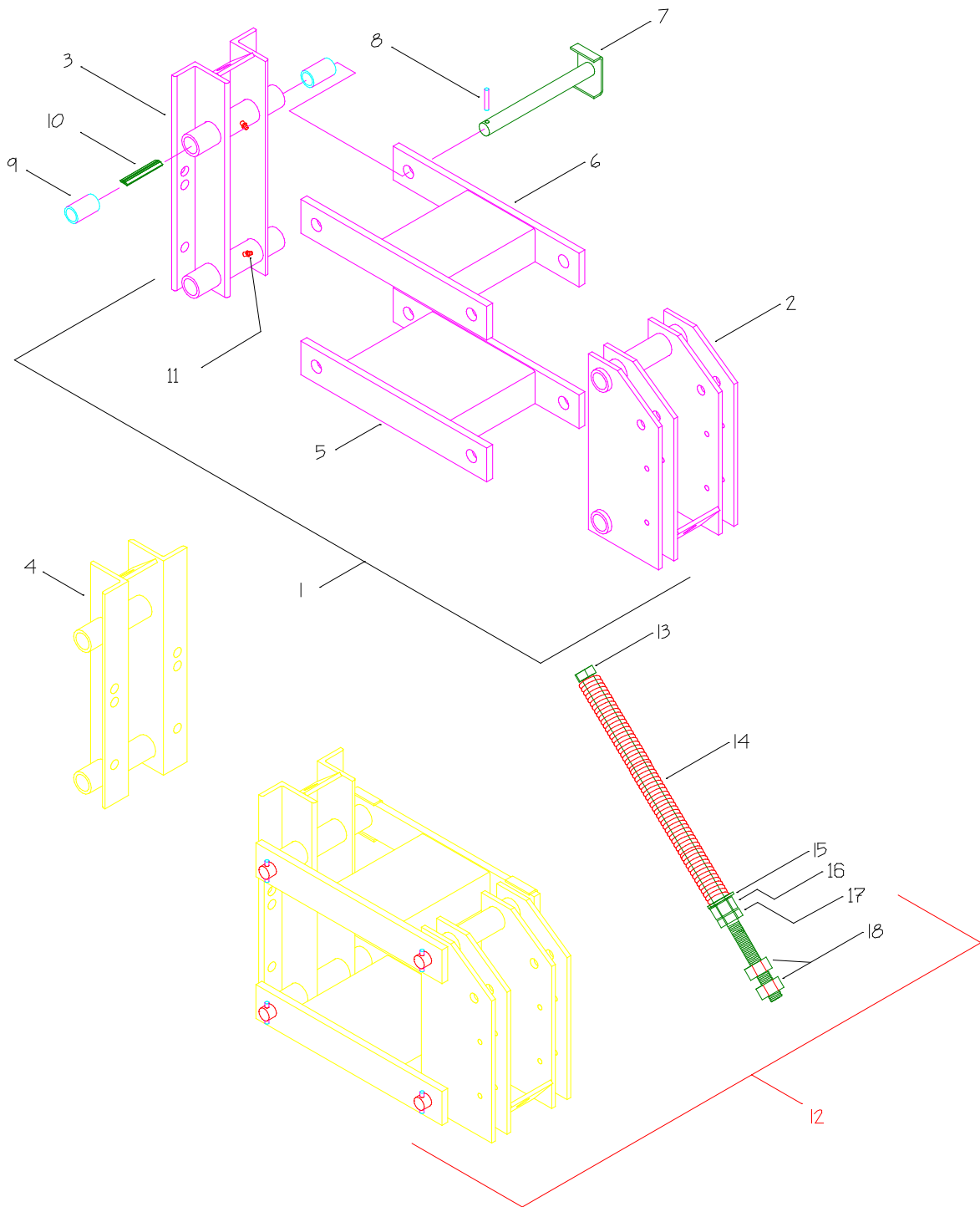

REF.	PART NO.	DESCRIPTION
1	500900	Linkage Assembly
2	500200	Rear Linkage Mount
3	500100	Front Parallel Mount
4	500120	Reverse Front Linkage Mount
5	500400	Lower Linkage
6	500300	Upper Linkage
7	500500	Linkage Pin
8	020965	1/4" x 1 1/2" Spring Lock Pin
9	200404	Linkage Bushing (Ryertex)
10	200405	Bushing Spacer
11	095036	1/4-28 NF Straight Zerk
12	501000	Linkage Assembly Complete
13	501050	Linkage Adjustment Bolt
14	501051	Compression Spring
15	020517	3/4" Flat Washer
16	020407	3/4" Nut
17	020447	3/4" Jam Nut
18	020428	3/4" Lock Nut

KNIFE SHANKS & GAUGE WHEELS

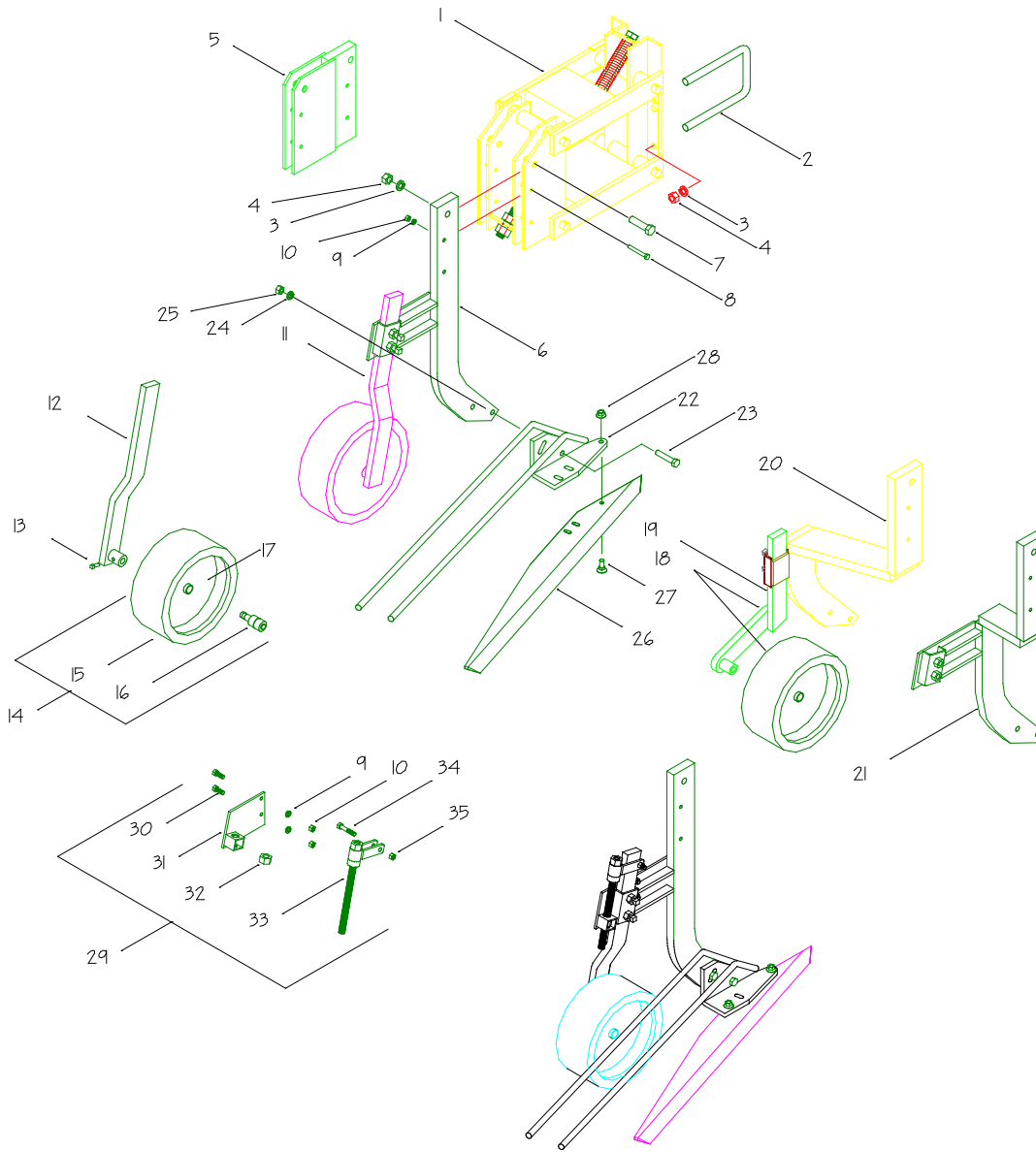

REF. PART #	DESCRIPTION
1	501000 Linkage Assembly Complete
2	021009 5/8" x 4" x 5 1/2" U-Bolt
	021012 5/8" x 5" x 8 1/2" U-Bolt
3	020506 5/8" Lock Washer
4	020406 5/8" Nut
5	500210 Spacer Block
6	500600 Row Shank
7	020066 5/8" x 2 1/2" Bolt
8	020019 5/16" x 2 1/2" Bolt
9	020501 5/16" Lock Washer
10	020401 5/16" Nut
11	501100 Row Gauge Wheel Assembly

KNIFE SHANKS & GAUGE WHEELS

REF.	PART NO.	DESCRIPTION
13	021361	5/16" x 3/4" Set Screw
14	090005	Tire Assembly
15	090021	Tire Rubber
16	095023	Bearing
17	090020	Rim Half
18	507600	Complete Offset Gauge Wheel Right
	507500	Complete Offset Gauge Wheel Left
19	507135	Offset Weldment Right 96 (22" Rows)
	507130	Offset Weldment Left 96 (22" Rows)
20	501400	Offset, Row Shank Right (22" Rows)
	501300	Offset, Row Shank Left (22" Rows)
21	501410	6" Offset, Row Shank Right (Used on Tractors where battery
	501310	6" Offset, Row Shank Left case or muffler interferes)
22	500700	Row Shoe, Right
	500800	Row Shoe, Left
23	020055	1/2" x 2 1/2" Bolt
24	020504	1/2" Lock Washer
25	020404	1/2" Nut
26	090041	48" Right Bean Knife (Hardsurfaced)
	090040	48" Left Bean Knife (Hardsurfaced)
	090051	48" Right Bean Cutter Blade
	090050	48" Left Bean Cutter Blade
	090045	54" Right Bean Knife
	090044	54" Left Bean Knife
	090046	54" Hardsurfaced Right Bean Knife
	090049	54" Hardsurfaced Left Bean Knife
	090091	Tupes 46" Bean Knife Right
	090090	Tupes 46" Bean Knife Left
	090093	Tupes 46" Hardsurfaced Knife Right
	090092	Tupes 46" Hardsurfaced Knife Left
	090095	Tupes 54" Bean Knife Right
	090094	Tupes 54" Bean Knife Left
	090097	Tupes 54" Hardsurfaced Knife Right
	090096	Tupes 54" Hardsurfaced Knife Right
27	020755	7/16" x 1 1/4" Plow Bolt
28	020481	7/16" Flange Nut
29	500610	Cutter Gauge Wheel Adjuster Package
30	020016	5/16" x 1" Bolt
31	500615	Adjustment Nut Holder
32	095056	5/8" Acme Nut
33	500620	Adjustment Rod Weldment
34	020031	3/8" x 2" Bolt
35	020423	3/8" Locknut

DOUBLE REAR LINKAGE ASSEMBLY

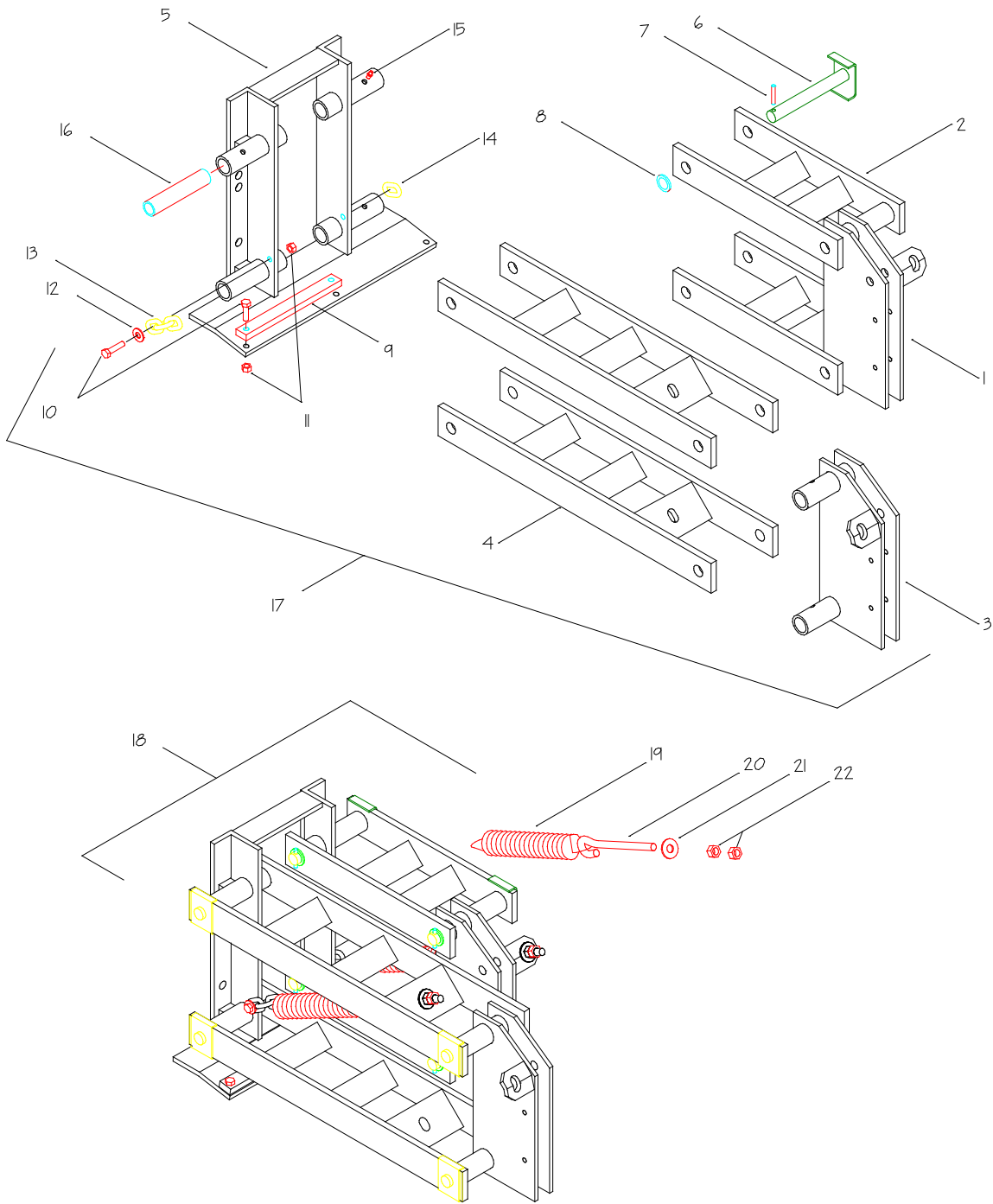

REF.	PART NO.	DESCRIPTION
1	510705	Rear Linkage Right
2	510715	Short Linkage Weldment
3	510700	Rear Linkage Left
4	510710	Long Linkage Weldment
5	510720	Front Linkage Mount
6	510730	Rear Linkage Pin
7	020965	1/4" x 1 1/2" Spring Lock Pin
8	021334	7/8" Narrow 14 Ga. Bushing
9	510745	Support Flat
10	020120	3/8" x 1 1/4" Bolt
11	020423	3/8" Center Locknut
12	020513	3/8" Flat Washer
13	510757	3 Link Chain
14	510756	1 Link Chain
15	095050	1/4-28 Straight Long Zerk
16	510735	Ryertex Bushing
17	510750	Double Rear Linkage Sub Assembly (Without Springs & Eyebolts)
18	510760	12-22 Dual Linkage Assembly '96 (With Springs & Eyebolts)
19	226600	Guide Disk Spring
20	300700	1/2" x 8" Eyebolt
21	020515	1/2" Flat Washer
22	020404	1/2" Nut

REAR MOUNT ASSEMBLIES

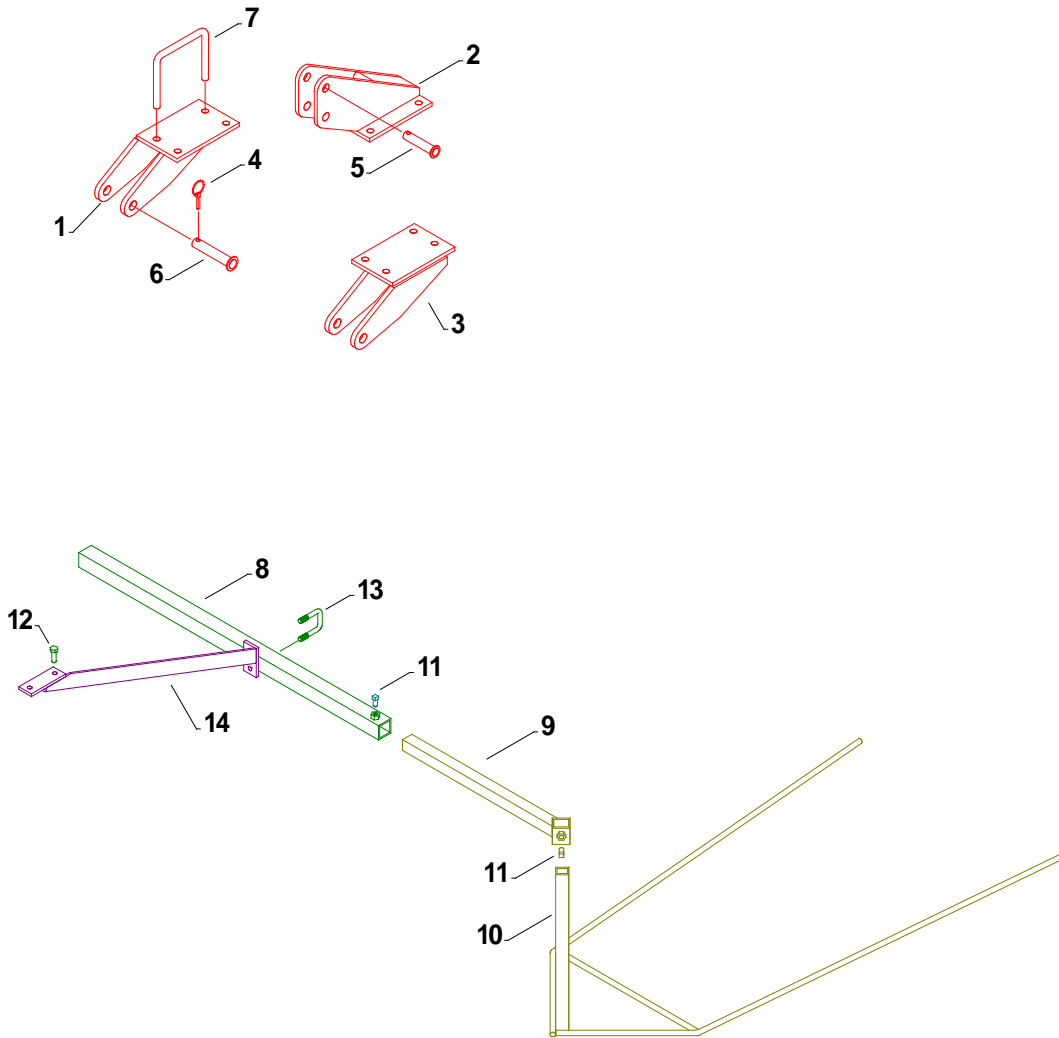

REF.	PART NO.	DESCRIPTION
1	220700	Lower 3 Point Hitch Left
2	220500	Upper 3 Point Hitch
3	220600	Lower 3 Point Hitch Right
4	095032	Lynch Pin
5	220900	Top 3 Point Pin
6	220800	Lower 3 Point Pin
7	021018	3/4" x 7" x 6 1/2" U-Bolt
8	503200	Divider Mount Rear Tube
9	503100	Rear Divider Mount
10	503300	Rear Row Divider
11	021362	Set Screw 1/2" x 1"
12	020052	1/2" x 1 1/2" Bolt
13	021000	1/2" x 2" x 3 1/2"
14	506400	Angle Bracket Left
	506800	Angle Bracket Right

TRACTOR MOUNTS

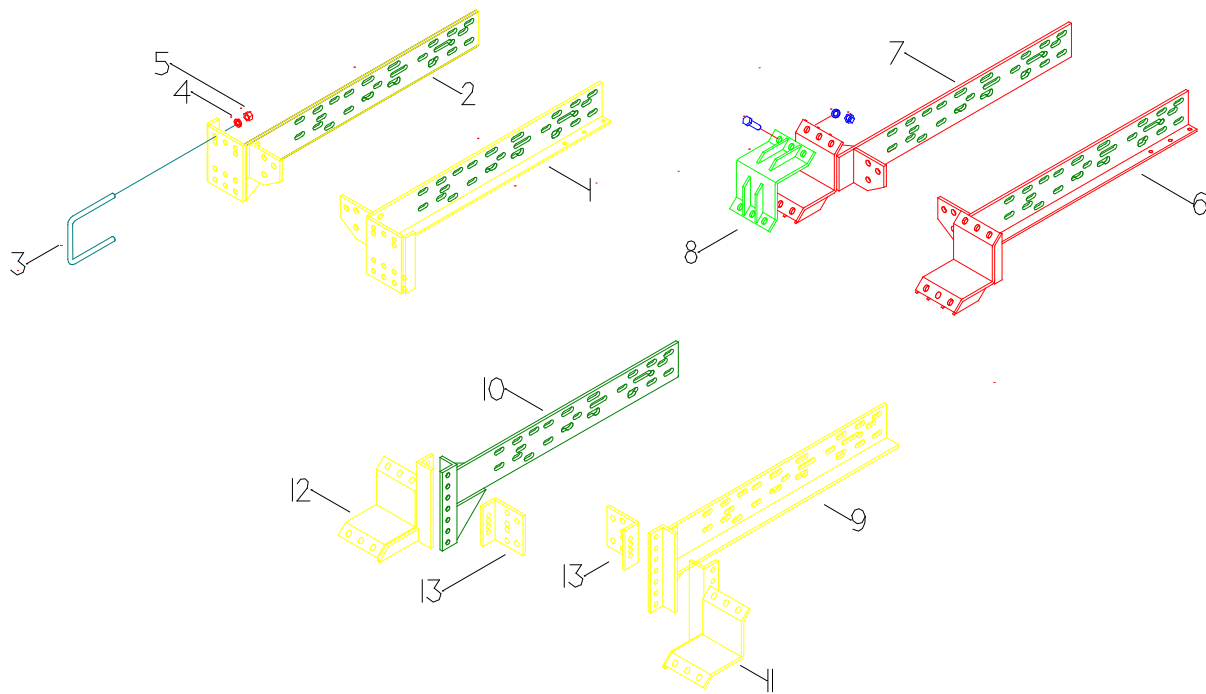

**Tractor mounts do not fit all makes and models
Some modification may be necessary**

REF.	PART NO.	DESCRIPTION
1	506200	Side Mount Left
2	506100	Side Mount Right
3	021037	3/4" x 7" x 8 1/2" U-bolt
4	020507	3/4" Lock Washer
5	020407	3/4" Nut
6	510330	Tractor Mount Weldment Left 1996
7	510340	Tractor Mount Weldment Right 1996
8	510345	Tractor Mount Backing Plate
9	510620	Adj. Tractor Mount Left Weldment
10	510610	Adj. Tractor Mount Right Weldment
11	510640	Adj. Toolbar Mount Left Weldment
12	510630	Adj. Toolbar Mount Right Weldment
13	510625	Front Tractor Mount

John Deere 8000 series:

Note: hole pattern on midmount linkage must be extended.

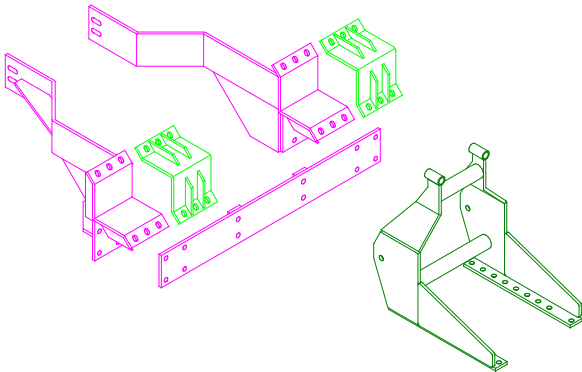

John Deere 7000 series

(2 whl drive)

Tractor mount plate moved 3" back and 1" up.
Cut long side plate down to 18" on
Some models.

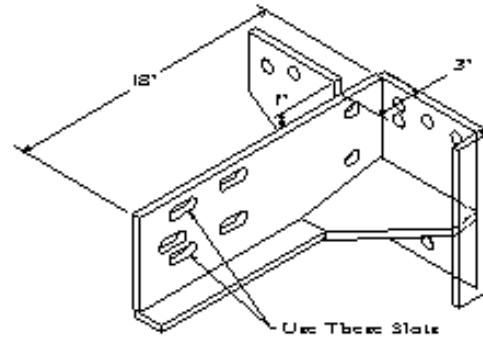

#562004 Rear Tire Divider Assembly

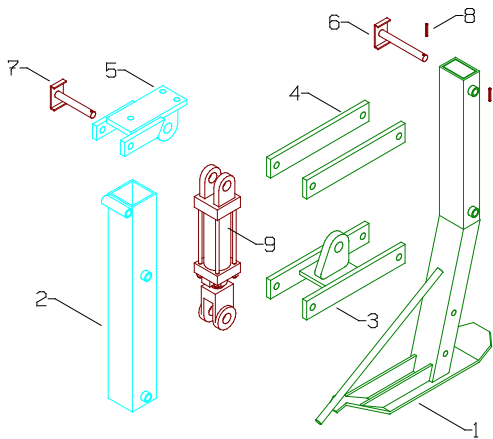

#562004 Rear Tire Divider Lift Package(Pair)

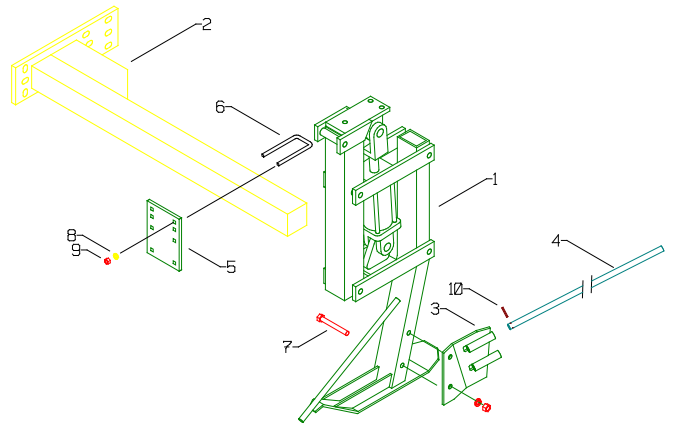

REF. PART NO. DESCRIPTION

1	503235	Rear Tire Divider Weldment
2	503240	Front Parallel Tube Weldment
3	503245	Lower Parallel Linkage
4	503248	Linkage Flat Painted
5	503250	Upper Cylinder Mount Wldmnt
6	503255	Tire Divider Pin
7	510400	Row Divider Pin
8	020958	3/16" x 1 1/4" roll Pin
9	095123	2" x 4" Cylinder 2500 psi

REF. PART NO. DESCRIPTION

1	503230	Rear Tire Divider Assy.
2	503260	Standard Divider Mount
3	522650	Divider Mount Left Weldment
	522650	Divider Mount Right Wldmnt
4	520398	Shoe Rod with Hole 1997
5	503700	Universal Bar Mount Plate
6	021004	1/2" x 3" x 7 1/4" u-bolt
7	020058	1/2" x 4" Bolt
8	020504	1/2" Lock Washer
9	020404	1/2" Nut
10	020965	1/4" x 1 1/2" roll pin

STEALTH UNIT TROUBLESHOOTING

PROBLEM	CAUSE	SOLUTION
Pushing too much dirt	<p>Blade too deep</p> <p>Blade at too much of an angle Shank too close to row</p> <p>Blades dull Tilt of blade may be off</p>	<p>Adjust gauge wheel to make blade run shallower</p> <p>Loosen blade bolts & straighten blade Measure cutter shank (See Blade setting on Page 11) Move shank to 8" away from row if necessary</p> <p>Sharpen or replace blades Reset Front of blade (See Blade setting on Page 14)</p>
Leaving too many beans	<p>Blade too shallow</p> <p>Blade not at enough angle</p> <p>Distance from shank to row is not correct</p> <p>Blades dull Tilt of blade may be off</p>	<p>Adjust gauge wheel to make blade run deeper</p> <p>Loosen blade bolts and move heel of blade out</p> <p>Measure cutter shank (See Blade setting on Page 11)</p> <p>Sharpen or replace blades Reset Front of blade (See Blade setting on Page 14)</p>
Divider Plowing	<p>Divider Shoe set to run too deep</p> <p>Point rod too Deep</p> <p>Linkage not mounted properly (Rear too high)</p> <p>Parallel Linkage & or Divider Mount Tubes bent</p>	<p>Adjust Divider Gauge Wheel to hold Bottom of Divider Shoe 3/4" off ground Adjust Point Rod so it barely enters soil Loosen bolts and adjust linkage (See Parallel Linkage on Page 14)</p> <p>Straighten or Replace</p>
Vines Plugging on Dividers and/or Blade Shanks	<p>Lodged Vines/White Mold</p> <p>Divider Rollers don't turn freely</p>	<p>Be sure Divider Point Rod is set so it is below the ground surface at all times.</p> <p>Increase speed</p> <p>Move Shanks further away from row Lubricate/Clean Roller shafts so Rollers turn freely</p>
Shelling Out Beans	<p>Beans too dry</p>	<p>Cut when there is a dew Move Blade Shank further away from rows to disturb beans less. Straighten Divider Rods to disturb beans less.</p> <p>Slow Down</p>

STEALTH UNIT TOOL BAR ASSEMBLIES

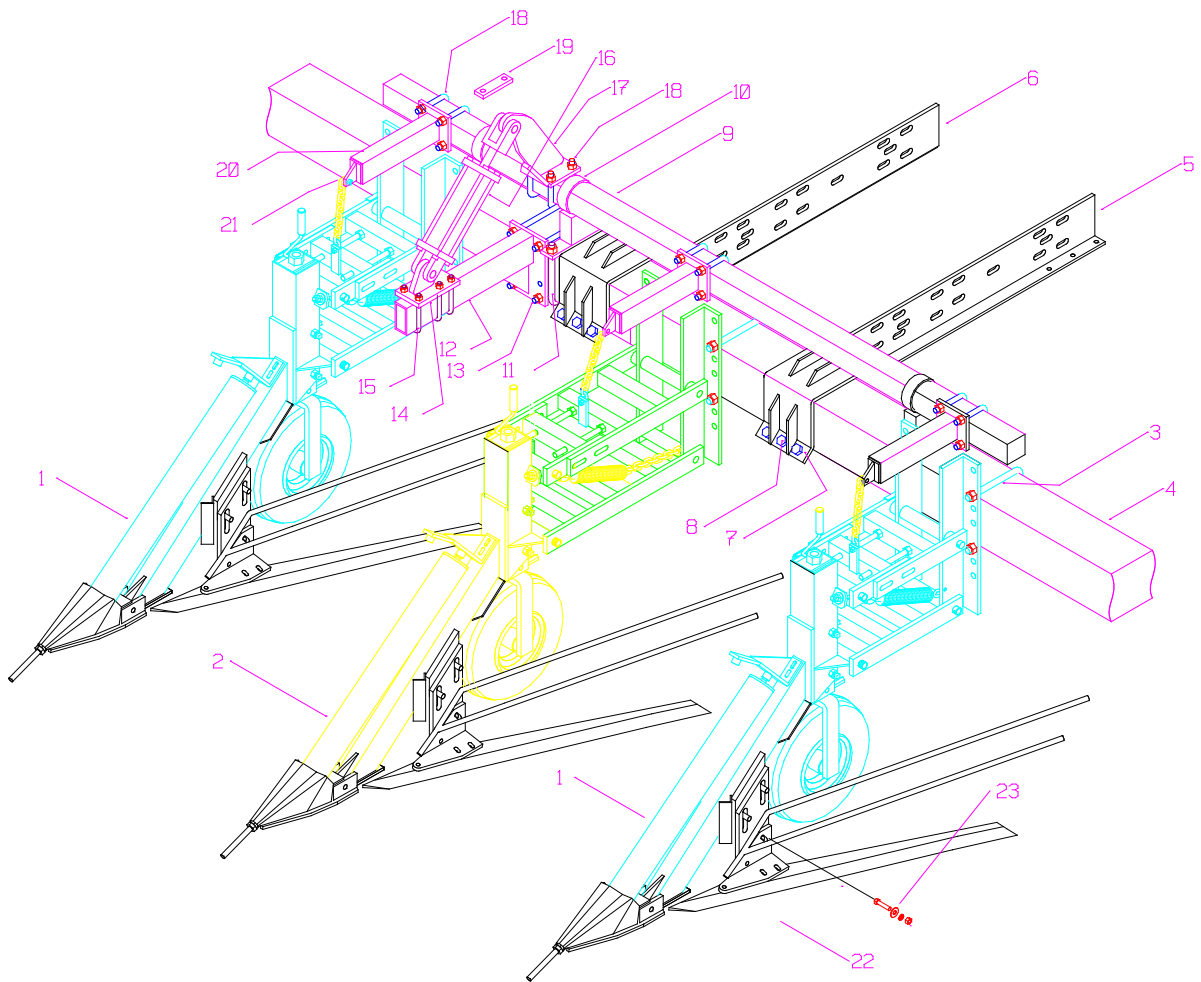

Note: Most configurations have short style stealth units in tire tracks.
Lift for stealth units may be placed elsewhere on the toolbar.

STEALTH UNIT TOOL BAR ASSEMBLIES

REF.	PART NO.	DESCRIPTION
1	511502	Stealth Divider/Cutting Unit Short
2	511501	Stealth Divider/Cutting Unit Long
3	021037	¾" x 7" x 8 ½" U-Bolt
	020407	¾" Lock Washer
	020507	¾" Nut
4	110776	7" x 7" x ¼" Tool Bar 240" Long (for 12/22 midmount)
	506540	4" x 4" Tool Bar 74" Long (For back of Midmount)
5		Tractor mount as required
6		Tractor mount as required
7	510345	Tractor Mount Backing Plate
8	020084	¾" x 3" Bolt
	020517	¾" Flat Washer
	020407	¾" Lock Washer
	020507	¾" Nut
9	510325	Front Lift Tube
10	510300	Pivot Pipe Weldment
11	021037	¾" x 7" x 8 ½" U-Bolt
12	505760	Cylinder Mount Bracket
13	021036	5/8" x 7" x 8 ½" U-Bolt
	020506	5/8" Lock Washer
	020406	5/8" Nut
14	505770	Divider Cylinder Mount Weldment
15	021001	½" x 2" x 5 ¼" U-Bolt
	020504	½" Lock Washer
	020404	½" Nut
16	095172	3" x 8" ORB Port Cylinder
17	510320	Cylinder Lift Arm Weldment
18	021007	5/8" x 3" x 4 ½" U-Bolt
	020506	5/8" Lock Washer
	020406	5/8" Nut
19	510305	Bar Mount Flat Painted
20	510315	Lift Arm Weldment
21	020030	3/8" x 1 ½" Bolt
	020513	3/8" Flat Washer
	020423	3/8" Lock Nut
22	090041	48" Right Bean Knife (Hardsurfaced)
	090040	48" Left Bean Knife (Hardsurfaced)
	090051	48" Right Bean Cutter Blade
	090050	48" Left Bean Cutter Blade
	090045	54" Right Bean Knife
	090044	54" Left Bean Knife
	090046	54" Hardsurfaced Right Bean Knife
	090049	54" Hardsurfaced Left Bean Knife
	090091	Tupes 46" Bean Knife Right
	090090	Tupes 46" Bean Knife Left
	090093	Tupes 46" Hardsurfaced Knife Right
	090092	Tupes 46" Hardsurfaced Knife Left
	090095	Tupes 54" Bean Knife Right
	090094	Tupes 54" Bean Knife Left
	090097	Tupes 54" Hardsurfaced Knife Right
	090096	Tupes 54" Hardsurfaced Knife Right
	020755	7/16" x 1 ¼" Plow Bolt
	020481	7/16" Flange Nut
23	020768	½" x 2" Carriage Bolt, Flat Washer, Lock Washer, Nut

STEALTH DIVIDER CUTTING UNITS SHORT

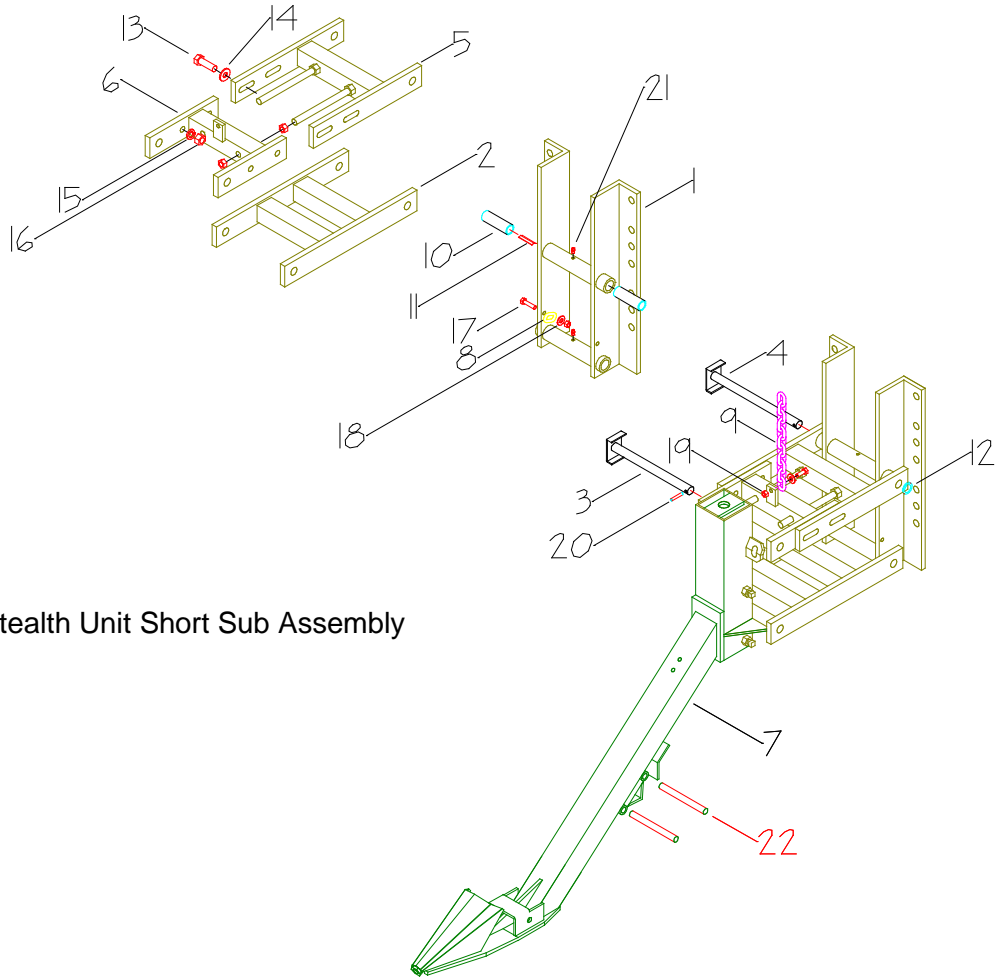

#510100 Stealth Unit Short Sub Assembly

#511502 Stealth Divider/Cutting Unit Short

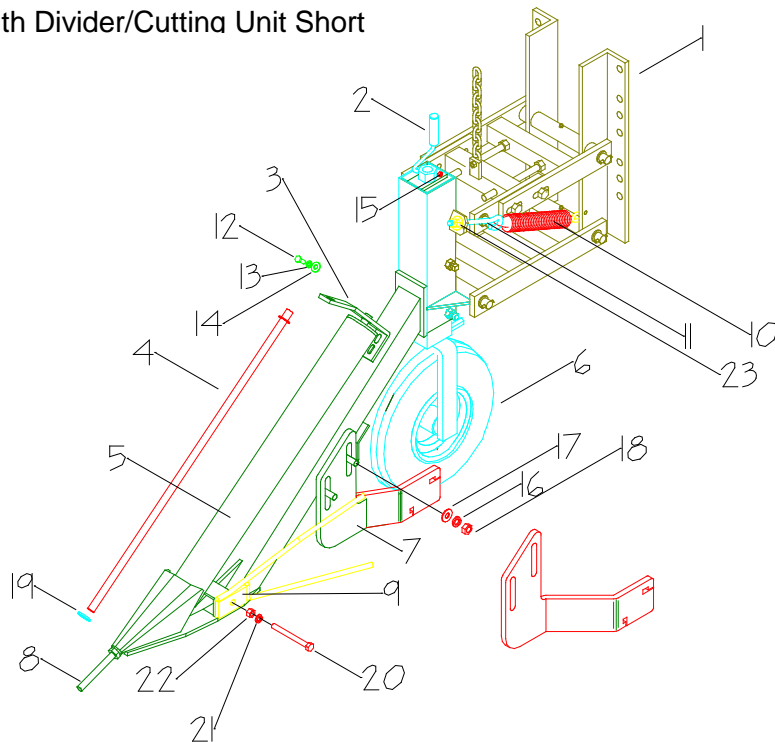

#510100 Stealth Unit Short Sub Assembly

REF.	PART NO.	DESCRIPTION
1	510230	Front Linkage Mount
2	510200	Linkage Weldment Short
3	200230	Lower Linkage Pin
4	510115	12 1/4" Linkage Pin
5	510250	Adj. Linkage Weldment Short Slot
6	510245	Adj. Linkage Weldment Short
7	510500	Stealth Divider Weldment 1998
8	510756	5/16" Chain Link
9	510103	5/16" Chain - 11 links
10	200434	Ryertex Bushing 3 7/16"
11	200631	Bushing Spacer
12	021334	7/8" Narrow 14 Ga Bushing
13	020065	5/8" x 2" Bolt
14	020536	5/8" Washer
15	020506	5/8" Lock Washer
16	020406	5/8" Nut
17	020030	3/8" x 1 1/2" Bolt
18	020513	3/8" flat Washer
19	020423	3/8" Center Lock Nut
20	020965	1/4" x 1 1/2" Spring Lock Pin
21	095036	1/4" 28 Straight Zerk
22	510520	5/8" x 6 1/4" alloy rod

#511502 Stealth Divider / Cutting Unit Short

REF.	PART NO.	DESCRIPTION
1	510100	Stealth Unit Short Sub Assembly
2	351240	Gauge Wheel Crank
3	510525	Upper Roller Mount 1998
4	510540	36" Roller Shaft 3/4" CR 1998
5	510430	32 5/8" Roller Assembly
6	510220	Gauge Wheel Assembly
7	510575	22" Offset Stealth Shank Left
	510580	22" Offset Stealth Shank Right
8	510146	Divider Point Bolt
9	510530	Stealth Guide Rod Left 1998
	510535	Stealth Guide Rod Right 1998
10	300600	Harrow Spring Painted
11	300700	1/2" x 8" Eye Bolt
12	020029	3/8" x 1" Bolt
13	020502	3/8" lock washer
14	020513	3/8" Flat Washer
15	020423	3/8" Lock Nut
16	020506	5/8" lock washer
17	020536	5/8" flat washer
18	020406	5/8" Nut
19	021313	3/4" narrow 14 Ga Bushing
20	020062	1/2" x 6" bolt
21	020504	1/2" Lock Washer
22	020404	1/2" Nut
23	020515	1/2" Flat Washer
24	510565	30" offset Shank Left
	510570	30" offset shank right

STEALTH DIVIDER CUTTING UNITS LONG

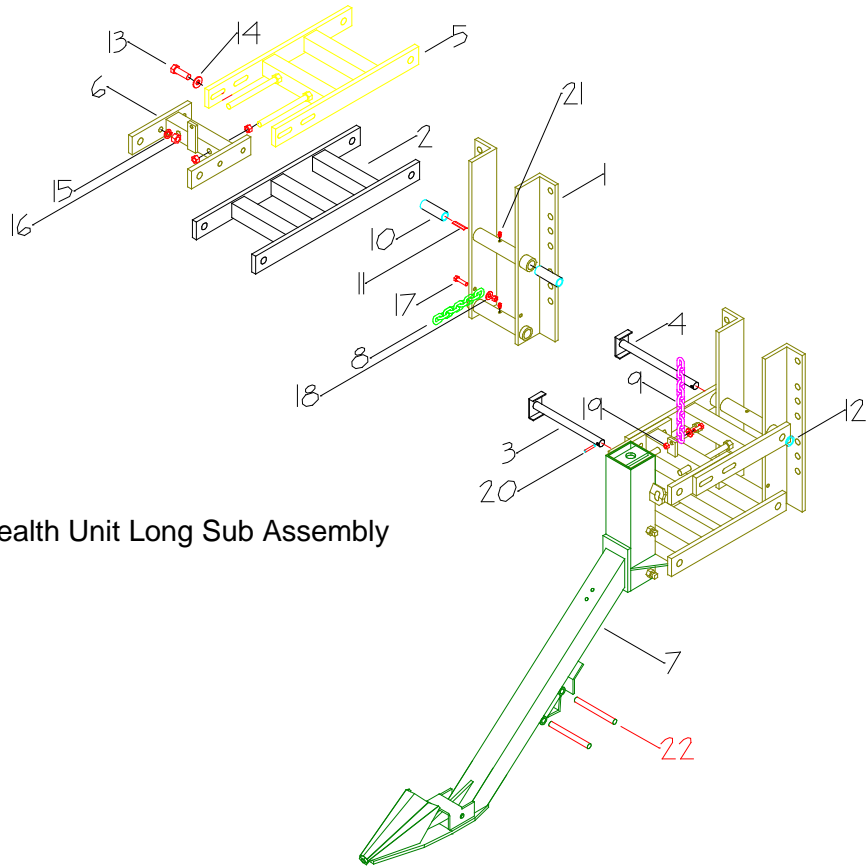

#510110 Stealth Unit Long Sub Assembly

#511501 Stealth Divider/Cutting Unit Long

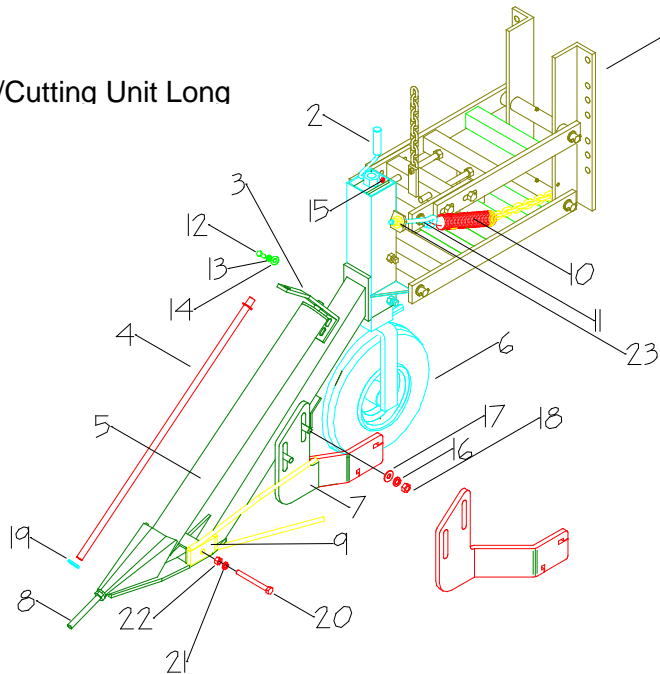

#510110 STEALTH UNIT LONG SUB ASSEMBLY

REF.	PART NO.	DESCRIPTION
1	510230	Front Linkage Mount
2	510205	Linkage Weldment Long
3	200230	Lower Linkage Pin
4	510115	12 1/4" Linkage Pin
5	510270	Adj. Linkage Weldment Long
6	510245	Adj. Linkage Weldment Short
7	510500	Stealth Divider Weldment 1998
8	510104	5/6" Chain Link - 9 links
9	510103	5/16" Chain - 11 links
10	200434	Ryertex Bushing 3 7/16"
11	200631	Bushing Spacer
12	021334	7/8" Narrow 14 Ga Bushing
13	020065	5/8" x 2" Bolt
14	020536	5/8" Washer
15	020506	5/8" Lock Washer
16	020406	5/8" Nut
17	020030	3/8" x 1 1/2" Bolt
18	020513	3/8" flat Washer
19	020423	3/8" Center Lock Nut
20	020965	1/4" x 1 1/2" Spring Lock Pin
21	095036	1/4" 28 Straight Zerk
22	510520	5/8" x 6 1/4" alloy rod

#511501 Stealth Divider / Cutting Unit Long

REF.	PART NO.	DESCRIPTION
1	510110	Stealth Unit Long Sub Assembly
2	351240	Gauge Wheel Crank
3	510525	Upper Roller Mount 1998
4	510540	36" Roller Shaft 3/4" CR 1998
5	510430	32 5/8" Roller Assembly
6	510220	Gauge Wheel Assembly
7	510575	22" Offset Stealth Shank Left
	510580	22" Offset Stealth Shank Right
8	510146	Divider Point Bolt
9	510530	Stealth Guide Rod Left 1998
	510535	Stealth Guide Rod Right 1998
10	300600	Harrow Spring Painted
11	300700	1/2" x 8" Eye Bolt
12	020029	3/8" x 1" Bolt
13	020502	3/8" lock washer
14	020513	3/8" Flat Washer
15	020423	3/8" Lock Nut
16	020506	5/8" lock washer
17	020536	5/8" flat washer
18	020406	5/8" Nut
19	021313	3/4" narrow 14 Ga Bushing
20	020062	1/2" x 6" bolt
21	020504	1/2" Lock Washer
22	020404	1/2" Nut
23	020515	1/2" Flat Washer
24	510565	30" offset Shank Left
	510570	30" offset shank right

GAUGE WHEEL ASSEMBLY -510220

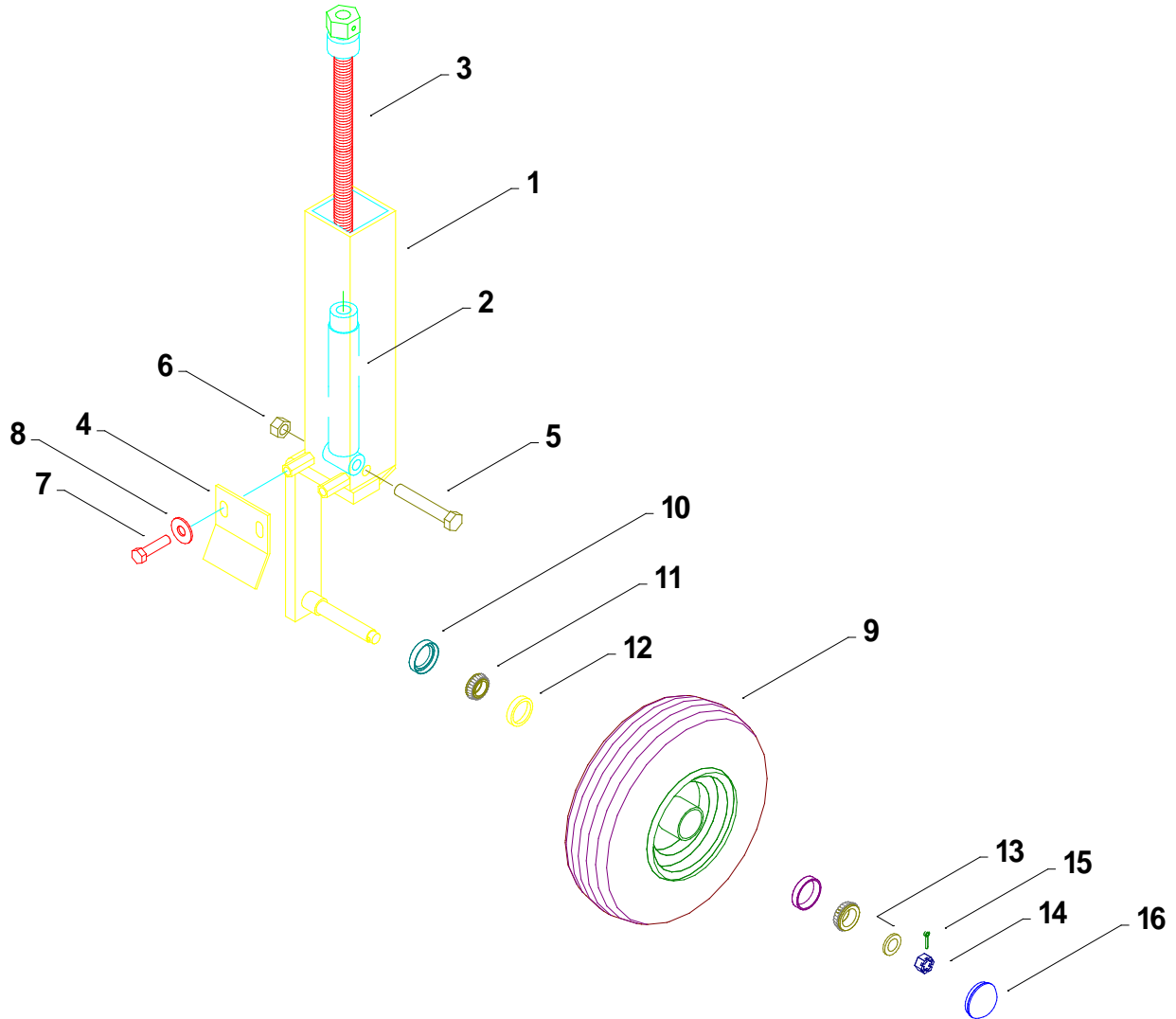

REF.	PART NO.	DESCRIPTION
1	510210	Gauge Wheel Tube Weldment
2	351220	Tube Upright
3	351230	Gauge Wheel Adjustment Screw
4	510218	Tire Scraper
5	020069	5/8" x 4" Bolt
6	020427	5/8" Lock Nut
7	020118	1/2" x 1 1/4" Bolt
8	020515	1/2" Flat Washer
9	096057	4.80 x 8 Tire Rim Assembly
10	095073	10035 Seal
11	095019	Tapered Bearing 3/4" LM 11949
12	095070	Bearing Cup 3/4" LM11910
13	021314	3/4" Narrow 10 Ga. Bushing
14	020490	3/4"-NF Hex Slotted Nut
15	020827	5/32" x 1" Cotter Pin
16	090014	DC10 Dust Cap

This Page Blank

HYDRAULIC SCHEMATICS

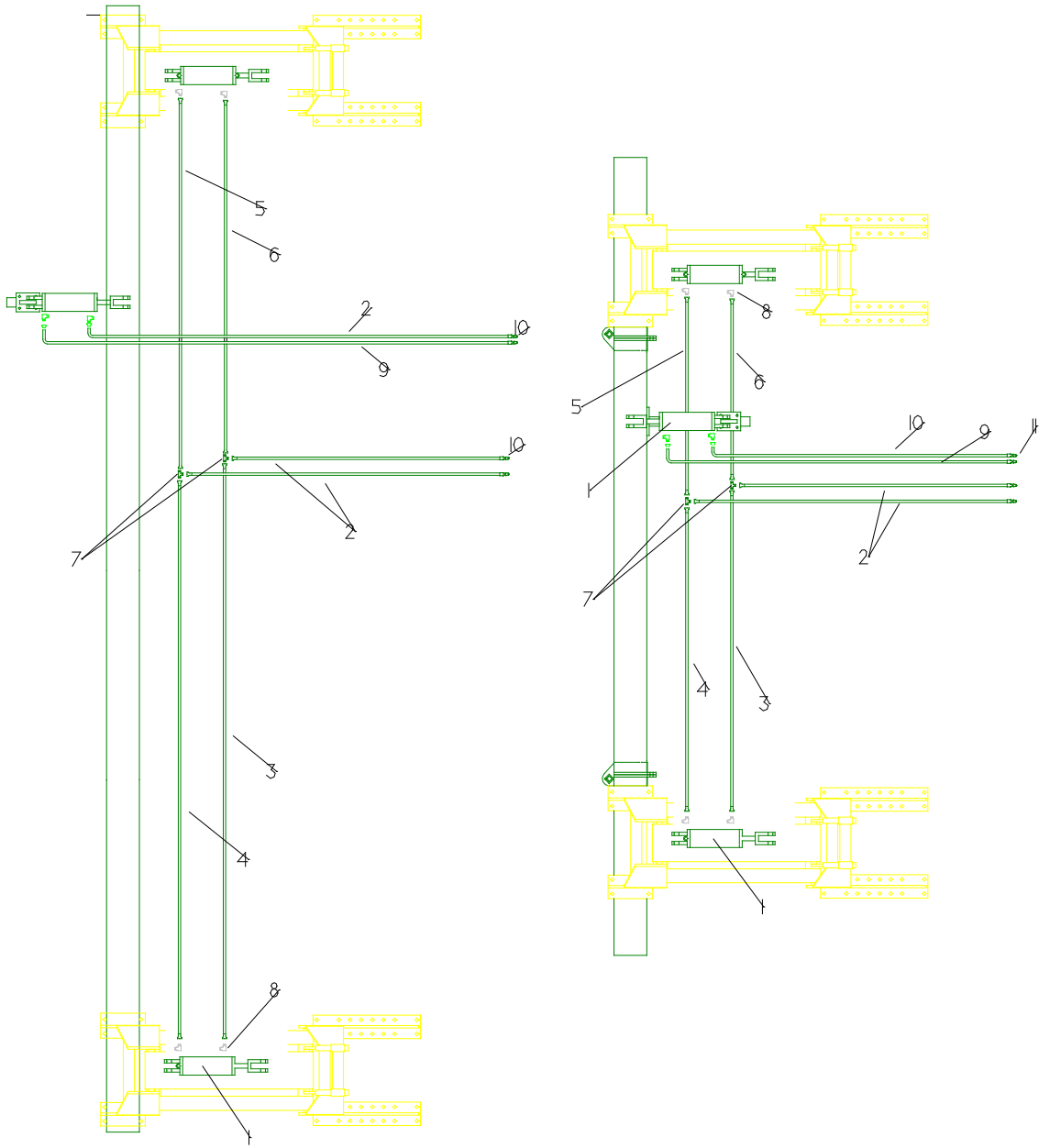

STEALTH MIDMOUNT COMBINATION

REF.	PART NO.	DESCRIPTION
1	0952172	3" X 8" 3/4 Orb Port Cylinder
2	510010	16' Hose Assembly
	095006	1/2" solid male 3/8" Hose End
	096072	9/16" Jic Swivel Female
3	510014	11'6" Hose Assembly
	096072	9/16" Jic Swivel Female
4	510013	10'6" Hose Assembly
	096072	9/16" Jic Swivel Female
5	510011	8' Hose Assembly
	096072	9/16" Jic Swivel Female
6	510012	9' Hose Assembly
	096072	9/16" Jic Swivel Female
7	095160	37° Jic 9/16 Tee 2603-6-6
8	095169	3/4" Orb x 9/16 Jic Elbow
9	510015	17' Hose Assembly
	095006	1/2" solid male 3/8" Hose End
	096072	9/16" Jic Swivel Female
10	095012	Universal Male Tip 1/2" Pioneer

Regular Midmount Cutter

REF.	PART NO.	DESCRIPTION
1	095072	3" x 8" 3/4 ORB Port Cylinder
2	509001	15' Hose Assembly
	096072	9/16" Jic Swivel Female
	095006	1/2" Solid Male 3/8" Hose End
3	509002	106" Hose Assembly
	096072	9/16" Jic Swivel Female
4	509003	94" Hose Assembly
	096072	9/16" Jic Swivel Female
5	509004	64" Hose Assembly
	096072	9/16" Jic Swivel Female
6	509005	76" Hose Assembly
	096072	9/16" Jic Swivel Female
7	095160	37° Jic 9/16 Tee 2603-6-6
8	095169	3/4" Orb x 9/16 Jic Elbow
9	509007	14' Hose Assembly
	096072	9/16" Jic Swivel Female
	095006	1/2" Solid Male 3/8" Hose End
10	509006	13' Hose Assembly
	096072	9/16" Jic Swivel Female
	095006	1/2" Solid Male 3/8" Hose End
11	095012	Universal Male Tip 1/2" Pioneer

ROW DIVIDER ASSEMBLY (ORIGINAL STYLE)

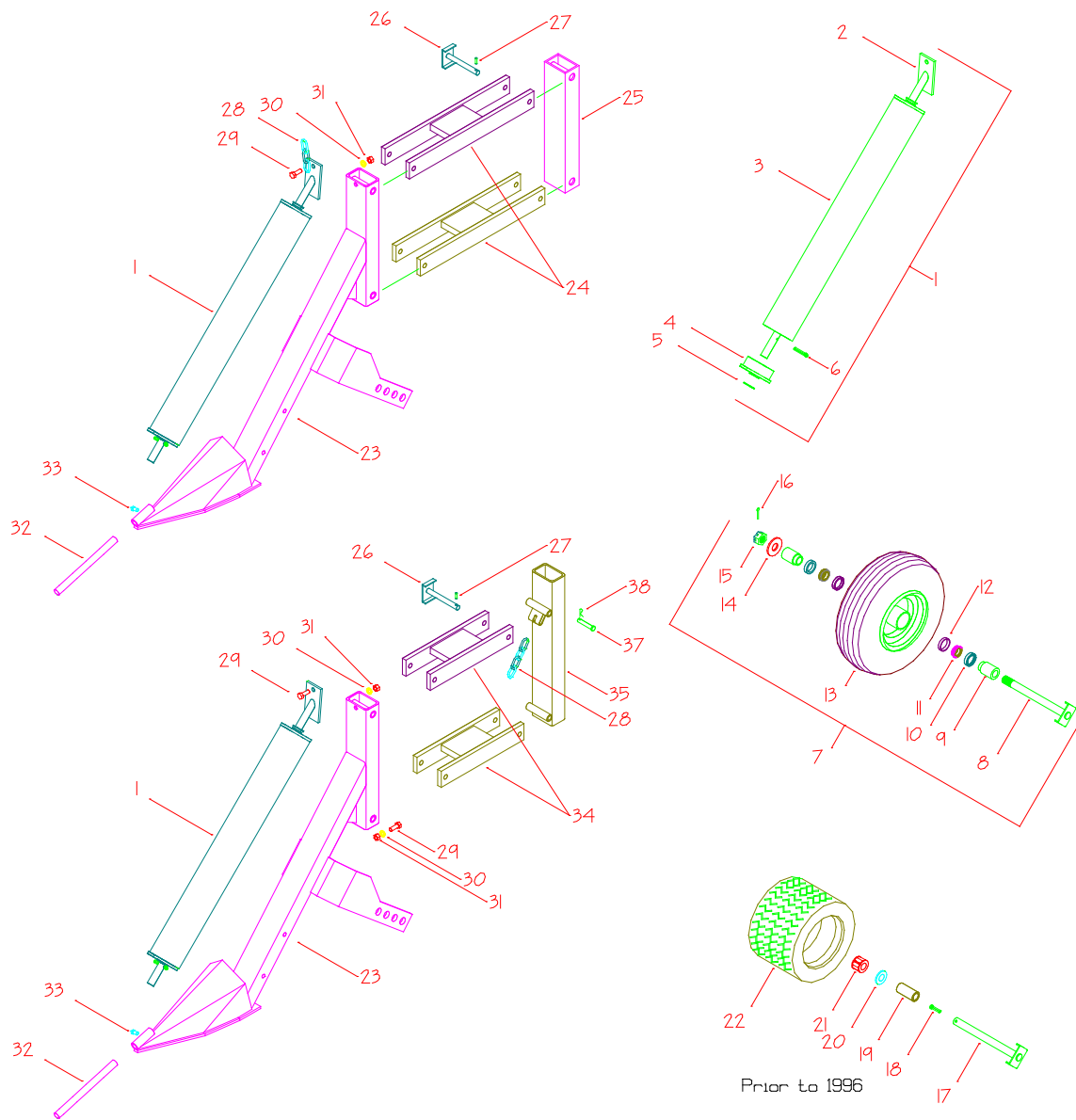

ROW DIVIDER ASSEMBLY

#503015 - Tractor Mount Row Divider less Rods

#503018 - Bar Mount Row Divider less Rods

#503055 - Divider Tractor Mount with Rods

#503058 - Divider Bar Mount with Rods

REF.	PART NO.	DESCRIPTION
1	501750	Complete Divider Roller
2	501702	Mount Shaft
3	501710	Roller Tubing
4	095090	Roller Cap
5	021313	3/4" Narrow 14 Gauge Bushing
6	020959	3/16" x 1 1/2" Spring Lock Pin
7	501620	Gauge Wheel Package (96)
8	501625	Threaded Spindle Weldment
9	501627	Gauge Wheel Spacer
10	095073	10035 Seal
11	095019	Tapered Bearing LM 11949
12	095070	Bearing Cup 3/4" LM 11910
13	090008	2010 Tire Rim Assembly
	090026	Tube for 13/500 x 6 Tire
	090027	13/500 x 6 Tire
	090019	2010 Rim with Race
14	021314	3/4" Narrow 10 Ga. Bushing
15	020490	3/4" NF Hex Slotted Nut
16	020827	5/32" x 1" Cotter Pin
17	502400	Divider Wheel Pin
18	020826	3/16" x 1 1/2" Cotter Pin
19	502700	Divider Wheel Spacer
20	090059	Roller Bearing Ends
21	090054	Roller Bearing
22	502900	Complete Tire Assembly
	090055	Tire Assembly (Less Hub)
	090056	Hub Assembly
	090039	13/650 Tire Only
23	501600	Row Divider Frame
24	502100	Divider Linkage 18"
25	502500	Front Bar 15"
26	502300	Row Divider Pin
27	020959	3/16" x 1 1/2" Spring Lock Pin
28	502800	Divider Chain
29	020030	3/8" x 1 1/2" Bolt
30	020502	3/8" Lock Washer
31	020402	3/8" Nut
32	501800	Divider Point Rod
33	021357	5/16" x 1/2" Square Head Set Screw
34	502200	Divider Linkage 12"
35	502600	Back Bar 18"
37	020860	1/4" x 2" Clevis Pin
38	020911	#2 Bridge Pin

1996 divider assembly (1st Year of Heavy Divider)

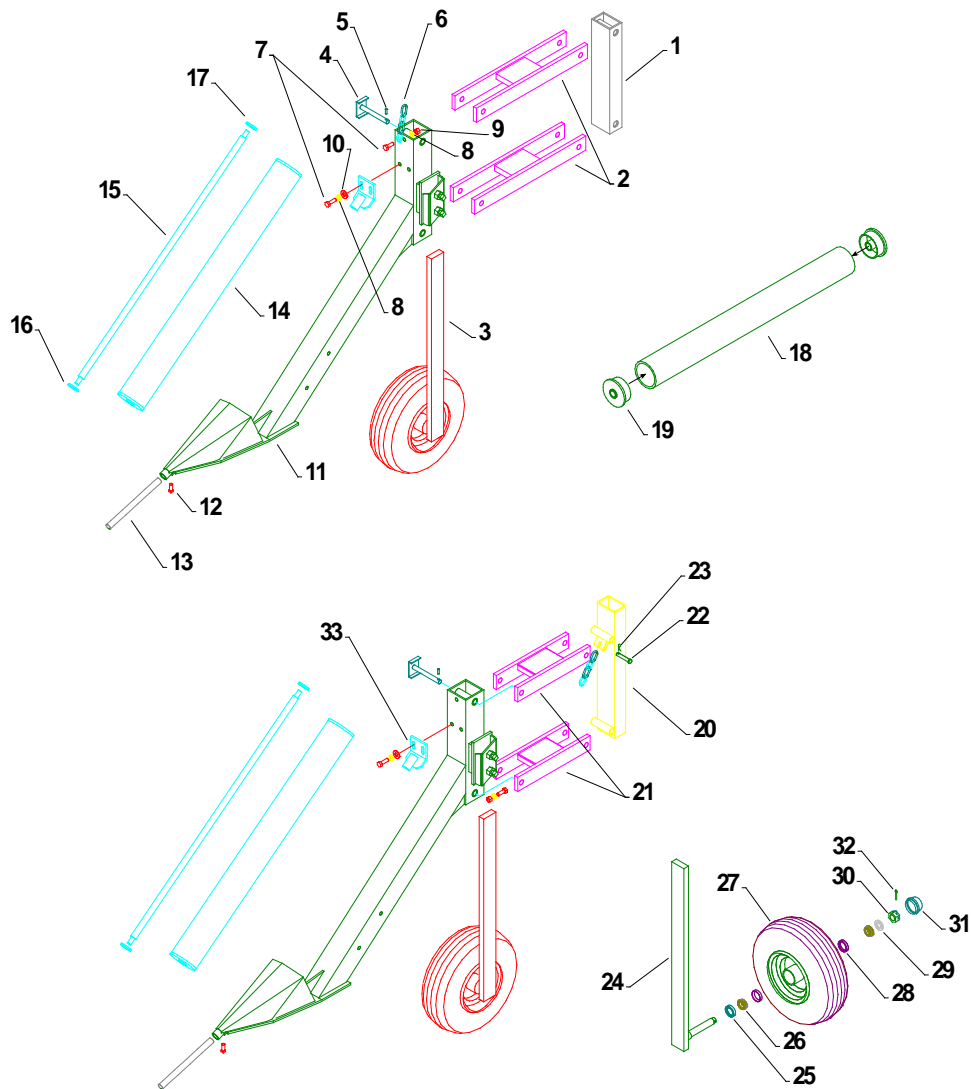

DIVIDER ASSEMBLIES 1996

REF.	PART NO.	DESCRIPTION
11	510370	Divider Weldment 1996 (Same number as 1998 divider, this style 1996 will not be offered)
12	021363	5/16 x 3/8" sq. hd set screw
13	501800	Divider Point Rod (9/16)
15	510432	3/4" Roller Shaft (Note: this shaft is machined down at both ends)
33	510385	Cone Mount Weldment

If replacing 1996 divider weldment with 1998 style-new roller shaft and upper mount is required. Also pointer bolt instead of 9/16" rod.

STEALTH ASSEMBLY 1997

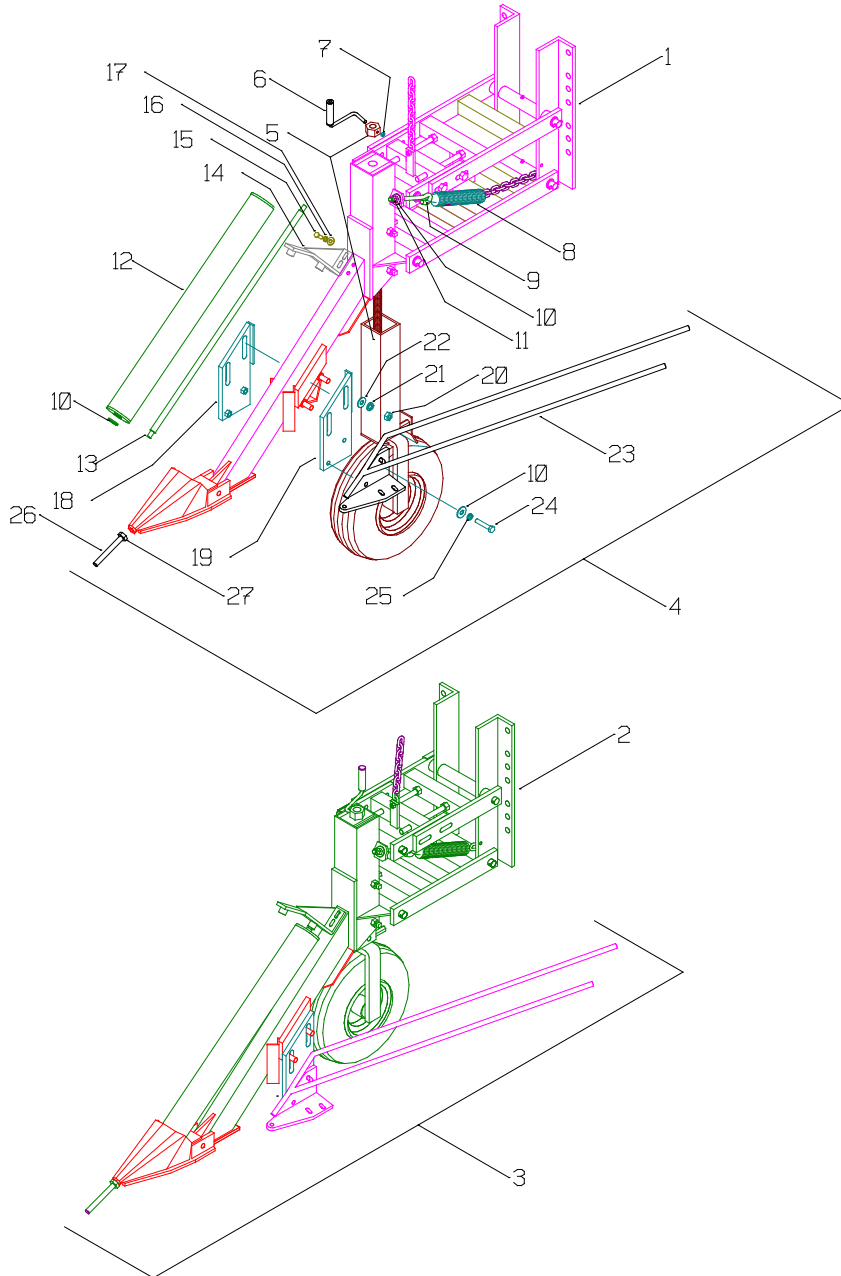

- | | | |
|----|-------------------|--|
| 13 | 510432 | 3/4" Roller Shaft
(Shaft is machined at both ends) |
| 14 | 510180 | Roller Mount Weldment |
| 18 | 510175 | Shoe Adjustment Plate-Right |
| 19 | 510176 | Shoe Adjustment Plate-Left |
| | 510190 | 30" offset shoe mount left |
| | 510195 | 30" offset shoe mount right
(these are weldments that bolt on the shoe) |
| | 510290 | Offset rod Weldment right 30" used also for 22" |
| | 510295 | Offset rod Weldment left 30" used also for 22" |
| | 510530 and 510535 | for 1998 can be used on older Stealths |

STEALTH ASSEMBLY 1997

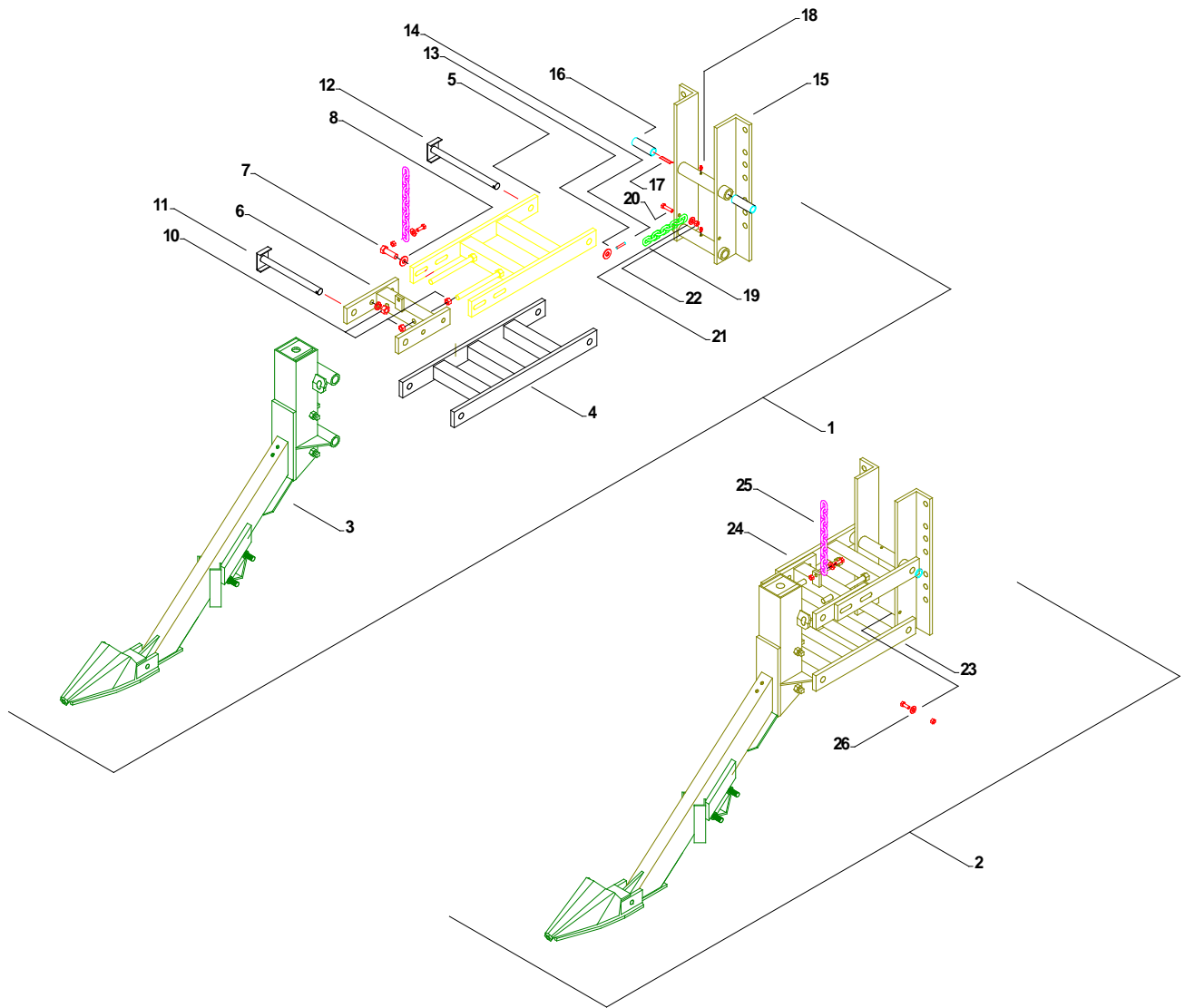

3 510150 Stealth Divider Weldment

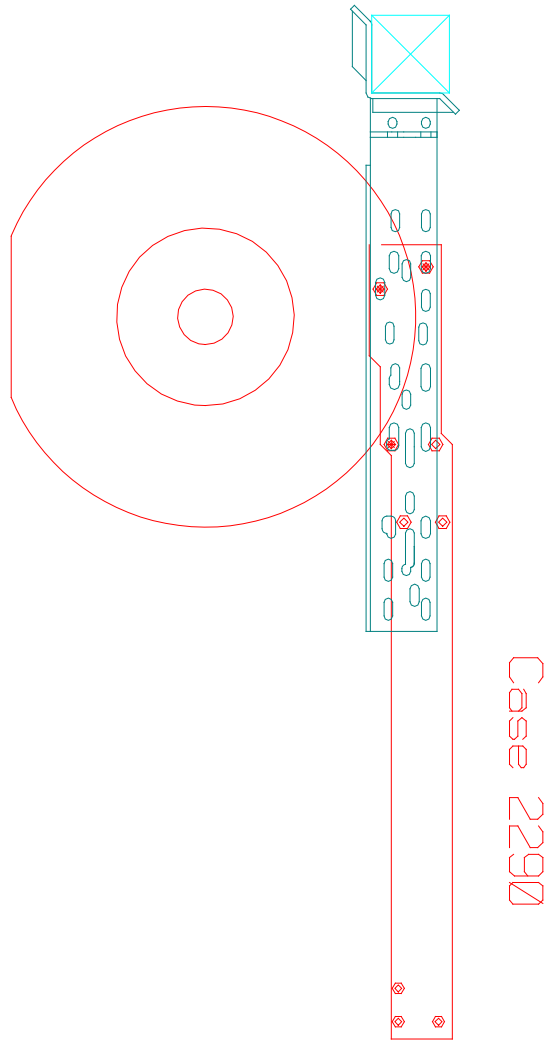
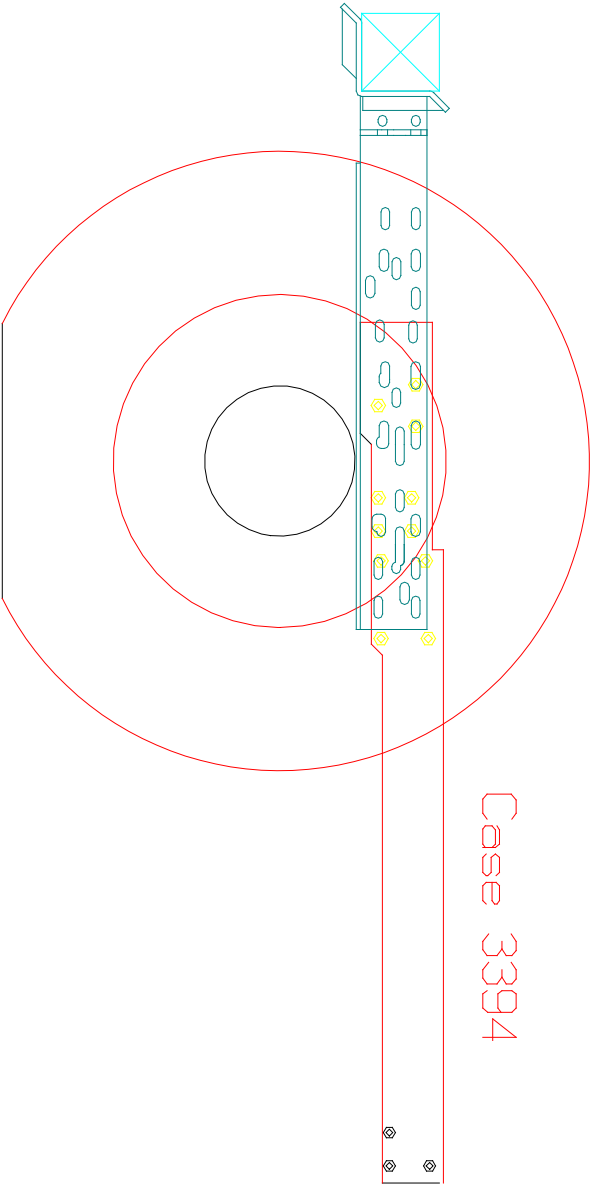

IH 5288

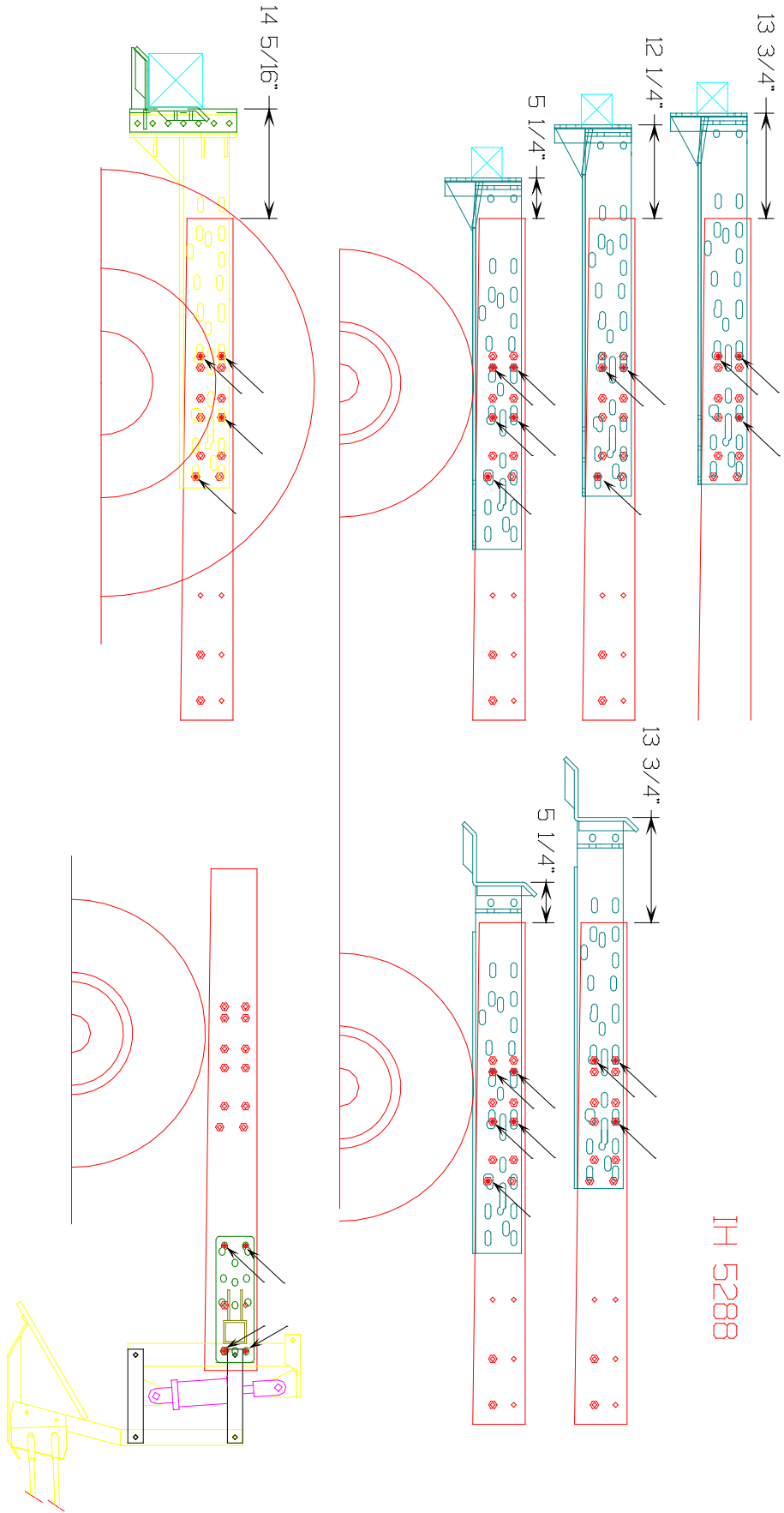

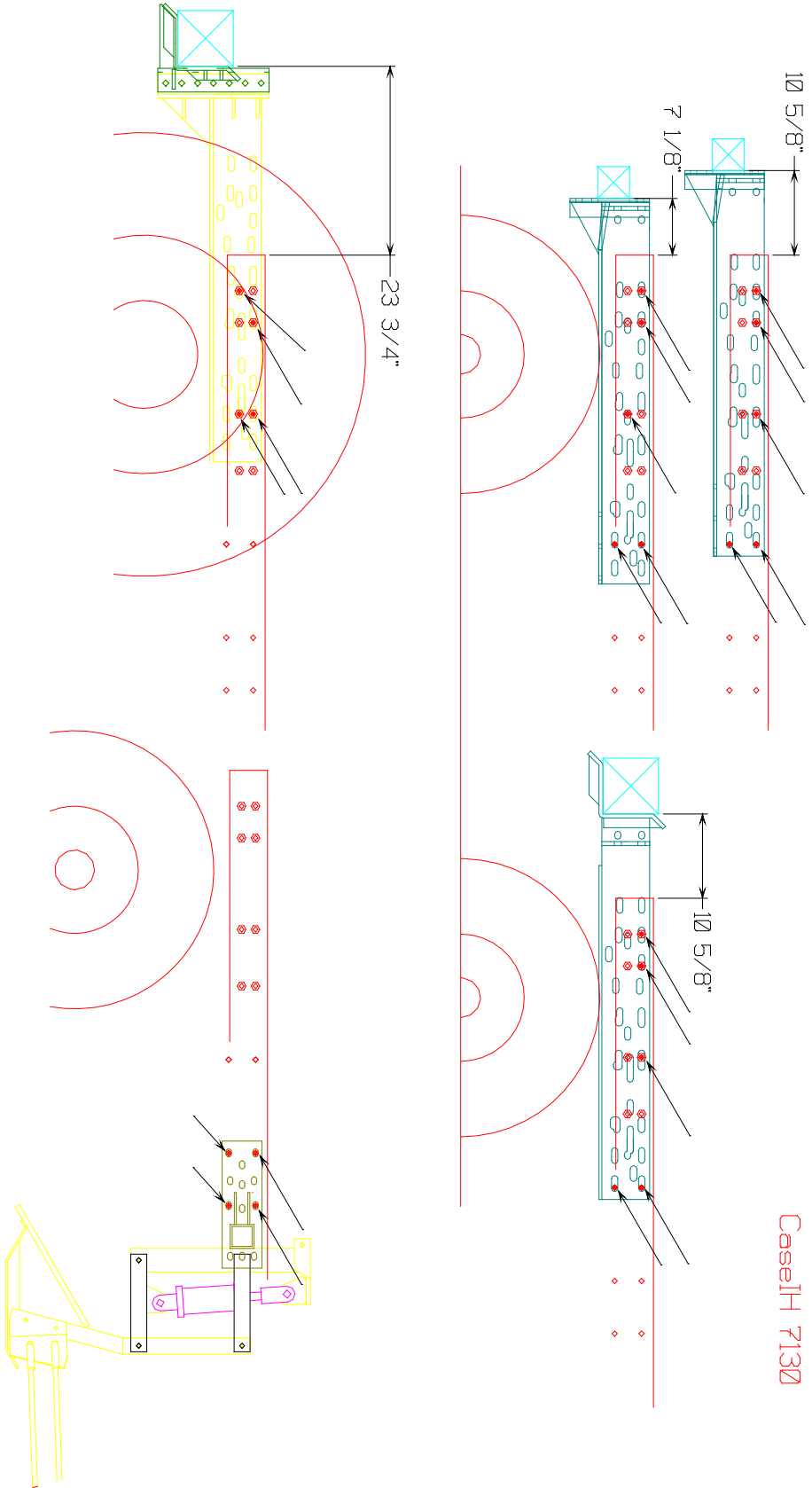

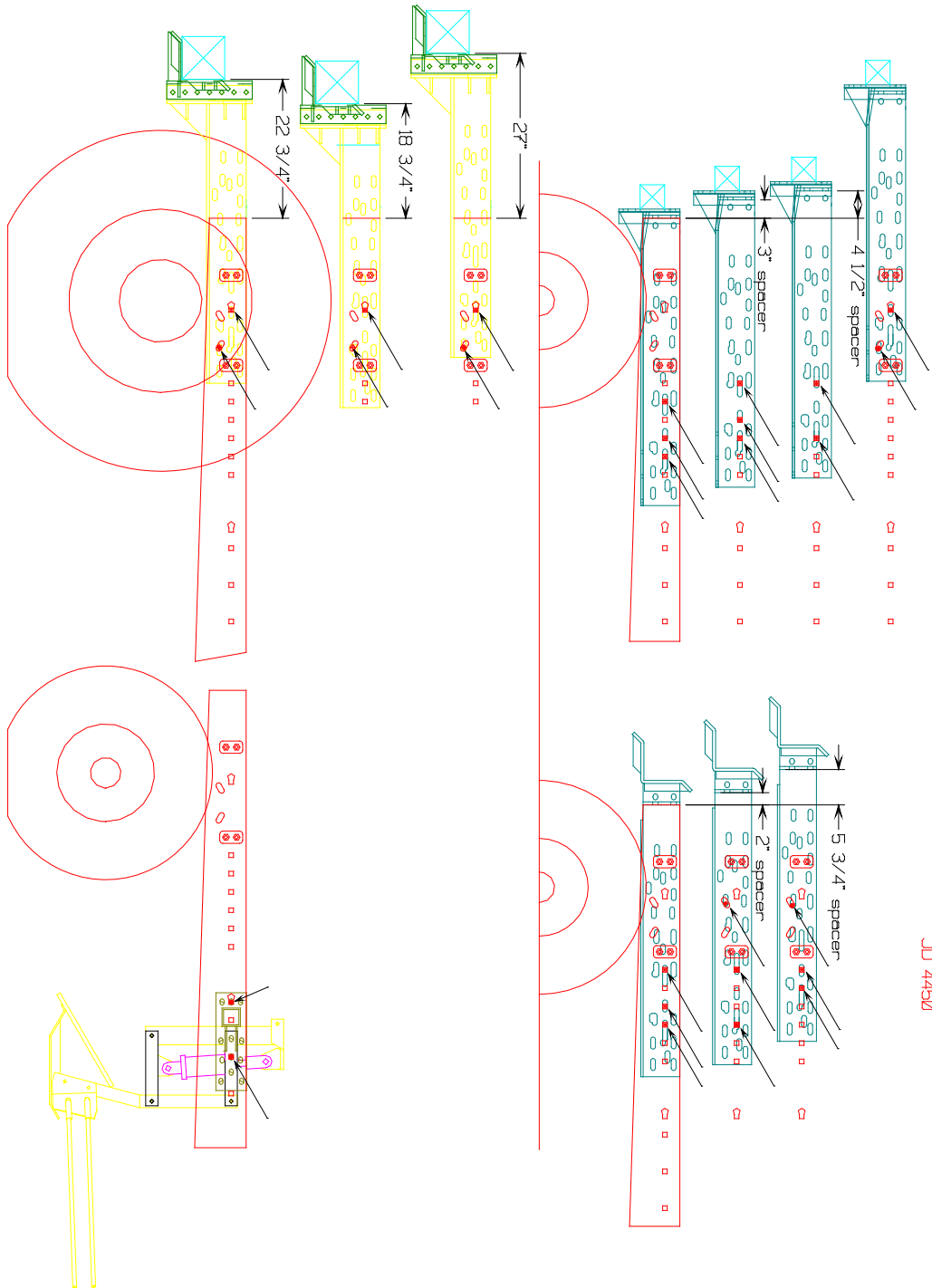

JD 4452

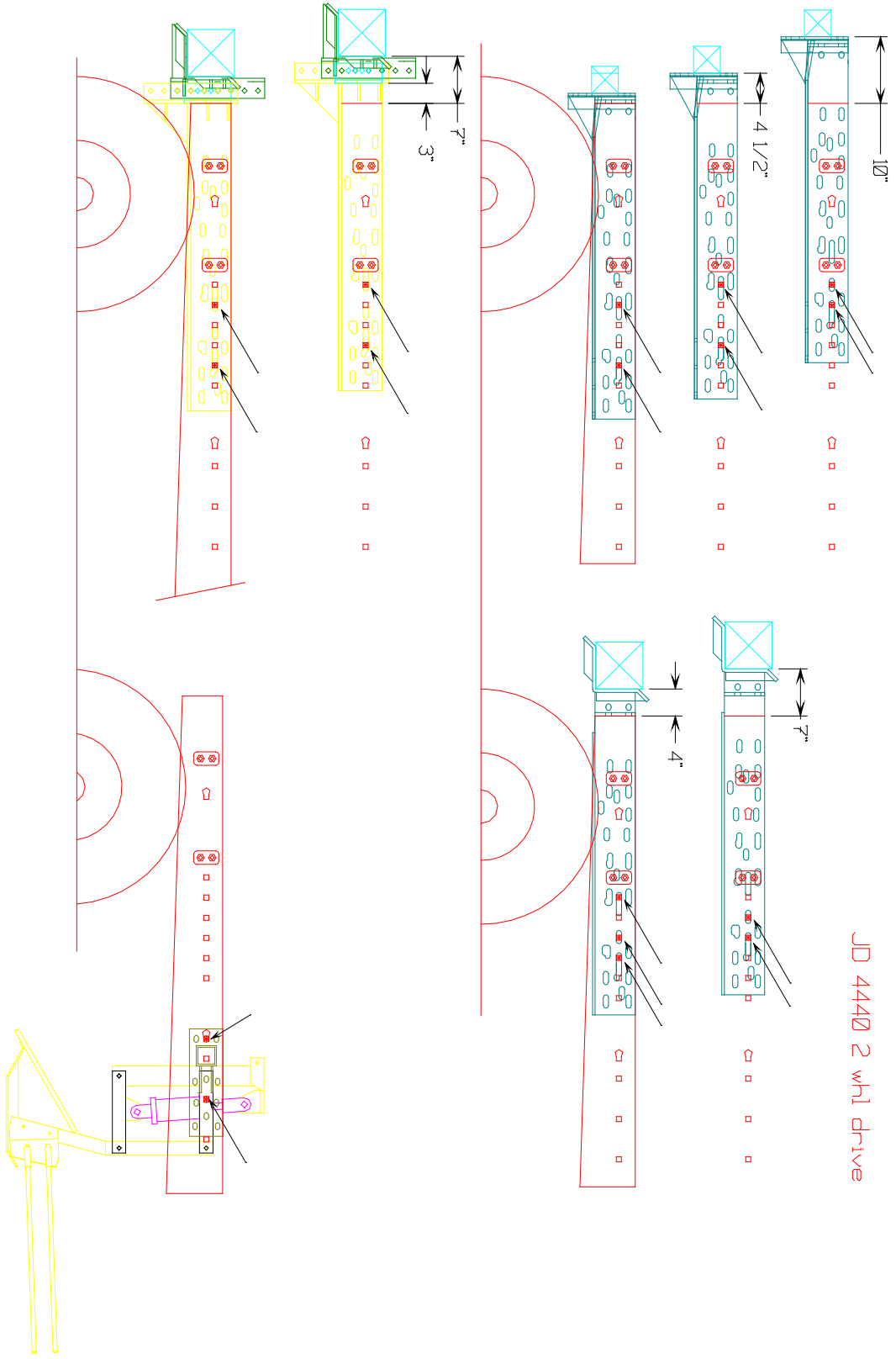

JD 4440 2 whl drive

Ford New Holland 8870

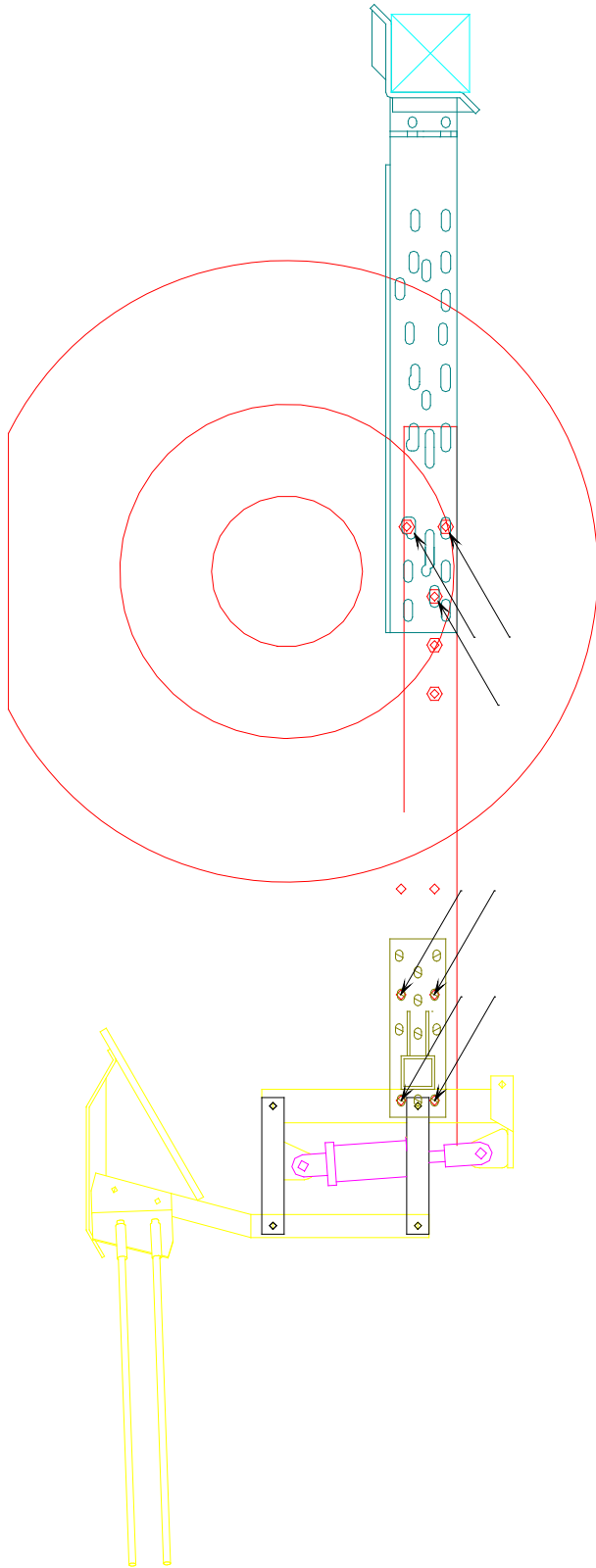

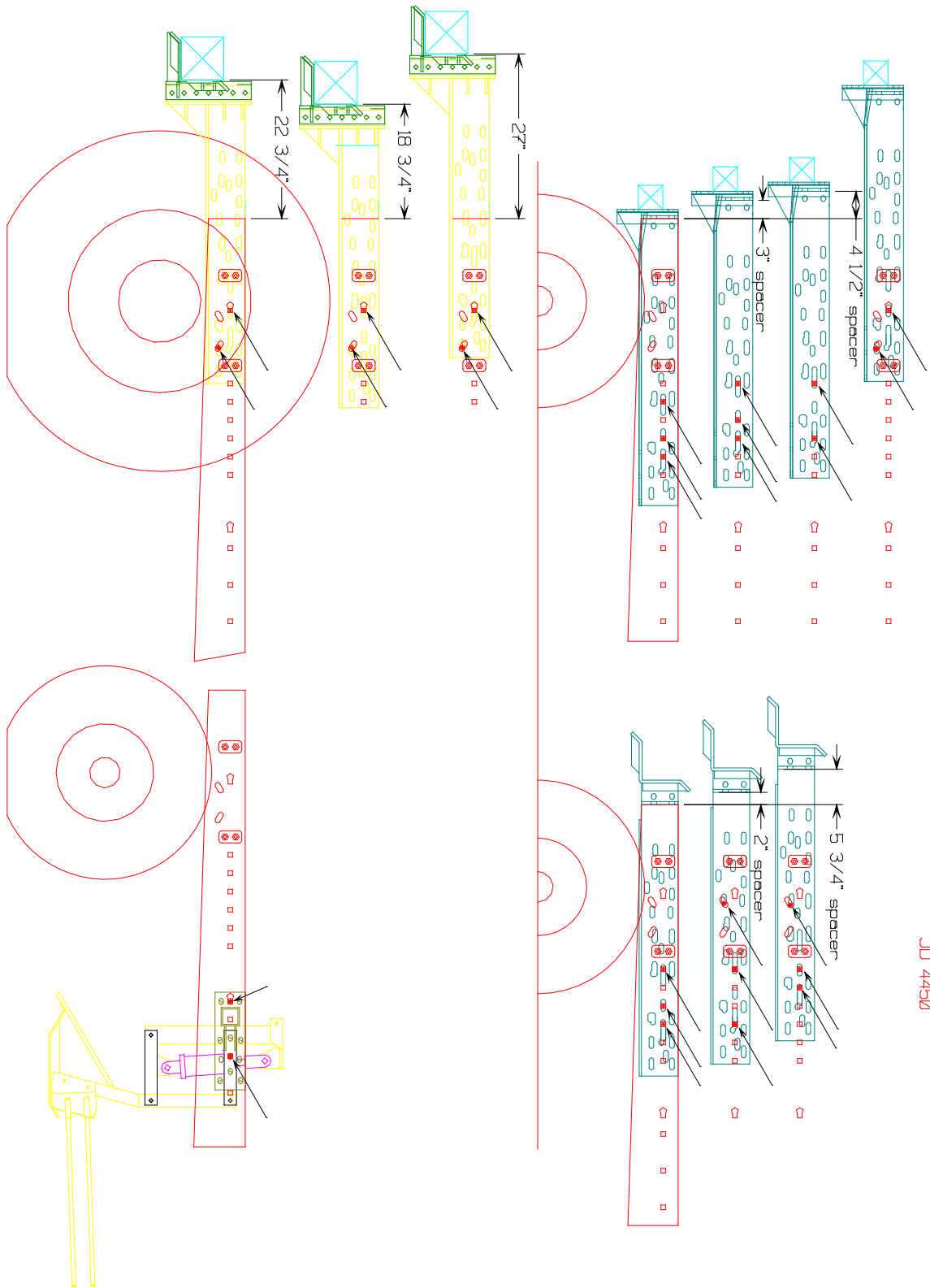

JD 4450

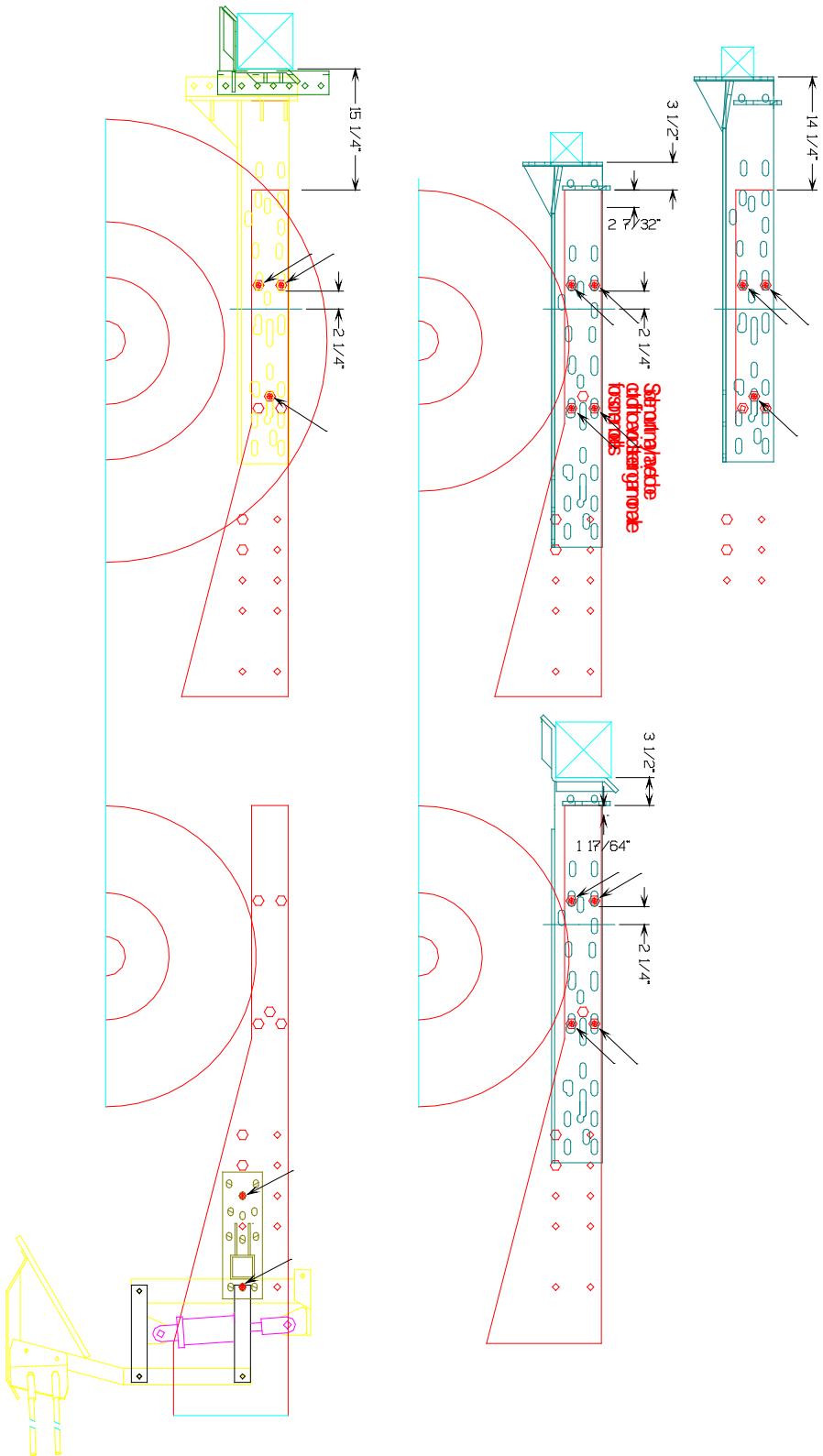

JD 7800

PUSH CUTTER MOUNTING LINKAGE

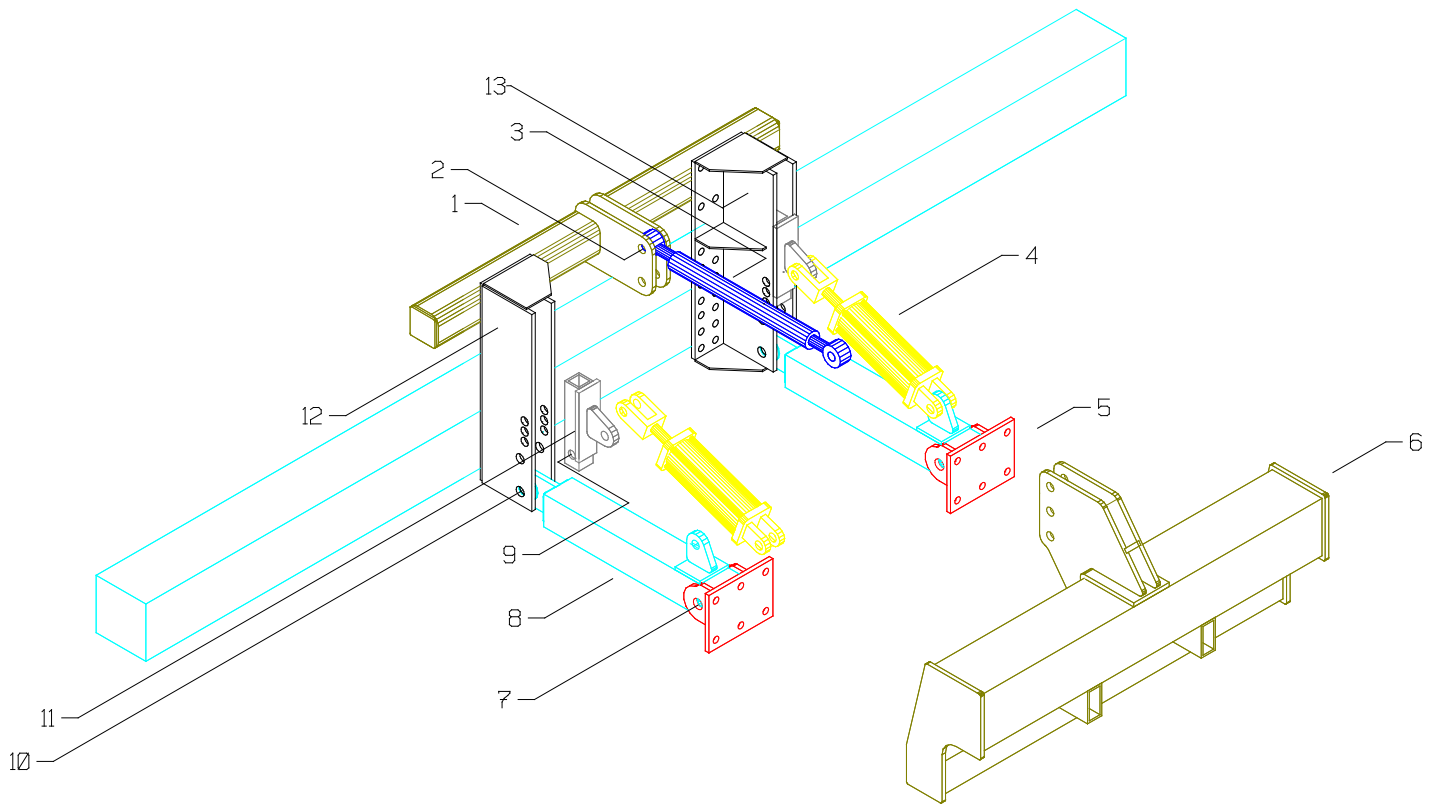

REF	PART NO.	DESCRIPTION
1	511680	Top 3 Pt. Crosstube Weldment
2	095278	Link Pin (P2325)
3	021204	Turnbuckle TL173
4	095109	3" Cyl. 3000# W/Stop ORB Port
5	511650	Rear Bottom Link Weldment
6	511670	Tractor Mount Rear Tube Weldment
7	511718	Lower Link Pin Weldment
8	511660	Bottom Link Tube
9	511715	Floating Cylinder Pin Weldment
10	511710	Pin Weldment
11	511690	Floating Cylinder Mount Weldment
12	511645	Front Link Mount Weldment Left
13	511640	Front Link Mount Weldment Right

PUSH CUTTER ROW LINKAGES

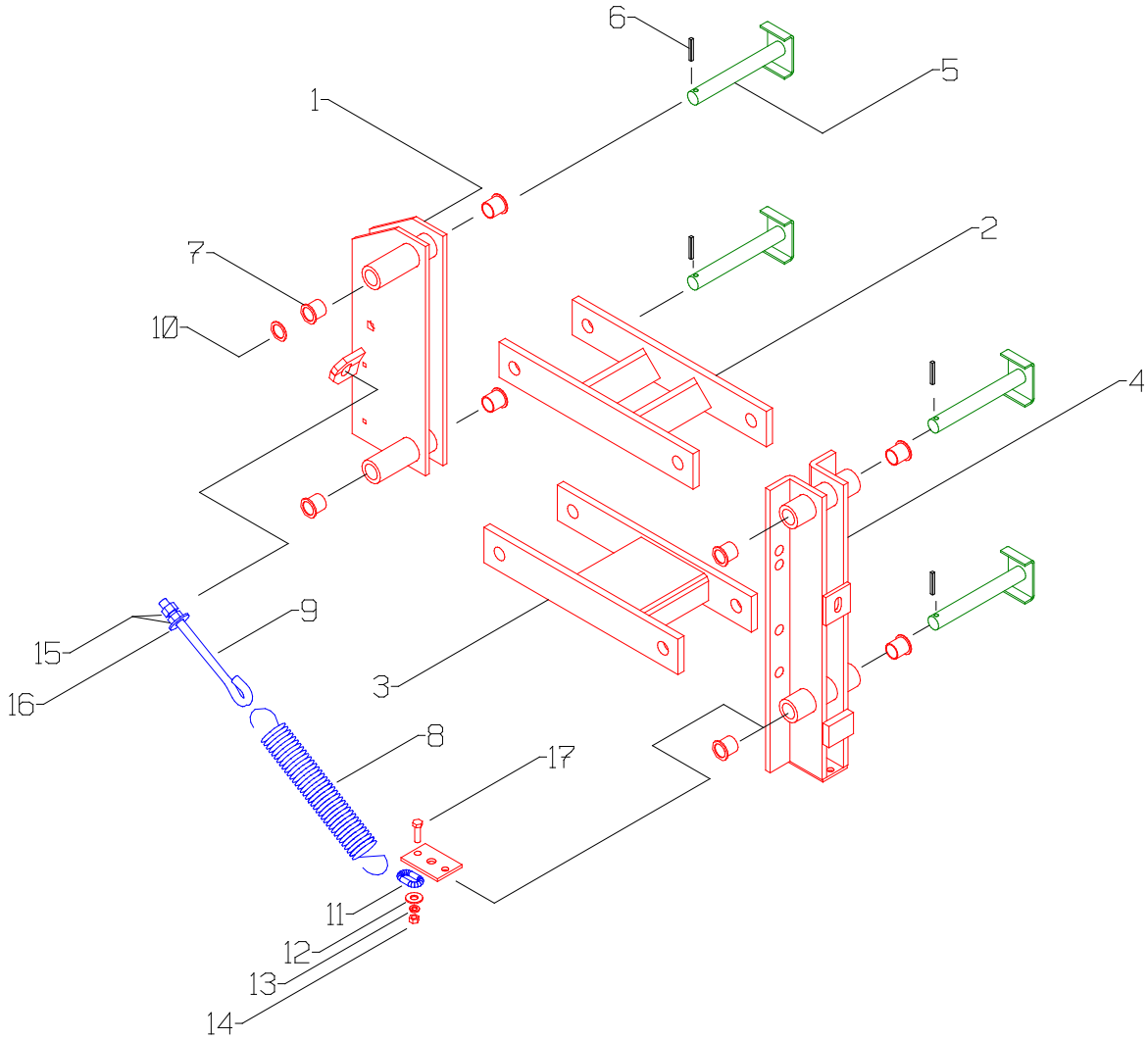

REF.	PART NO.	DESCRIPTION
1	511620	Rear Linkage Right
2	510715	Short Linkage Weldment
3	511610	Lower Linkage Weldment
4	511630	Front Linkage Weldment
5	510730	Rear Linkage Pin
6	020965	¼" x 1 ½" Spring Lock Pin Plain
7	090155	1" x 7/8" Plastic Insert
8	300600	Harrow Spring (Painted)
9	300700	½" x 8" Eye Bolt
10	021334	7/8" Narrow 14 Ga. Bushing
11	510756	1 Link Chain
12	020513	Washer, 3/8" Flat
13	020502	Washer, 3/8" Lock
14	020402	Nut, 3/8" NC
15	020404	Nut, ½" NC
16	020515	Washer, ½" Flat
17	020120	Bolt, 3/8" x 1 ¼" NC GR #5

PUSH CUTTER ROW LINKAGES COMPLETE

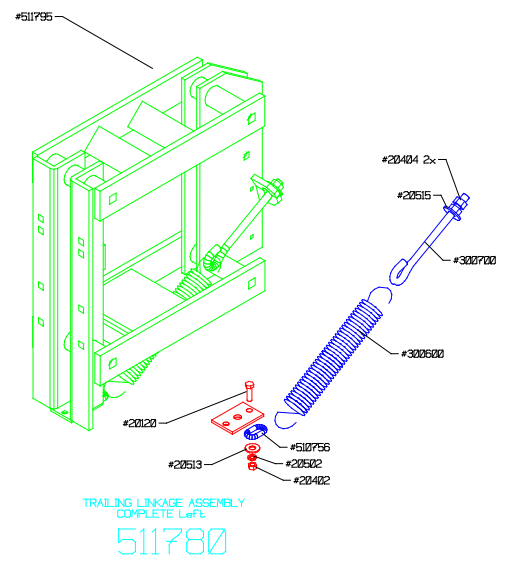
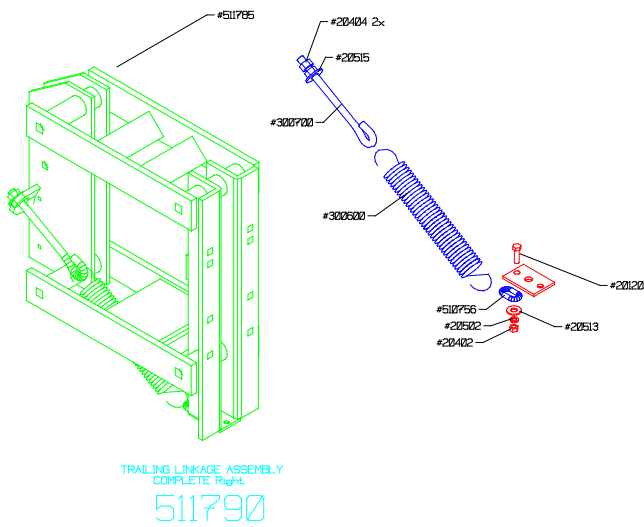
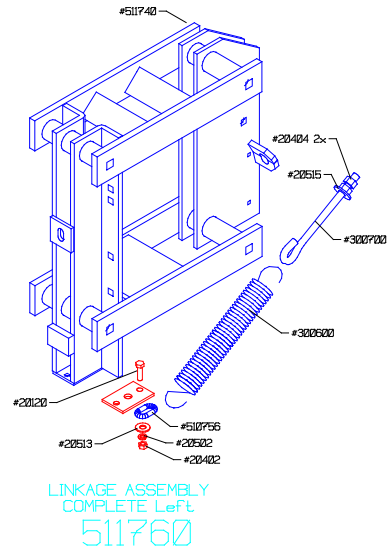
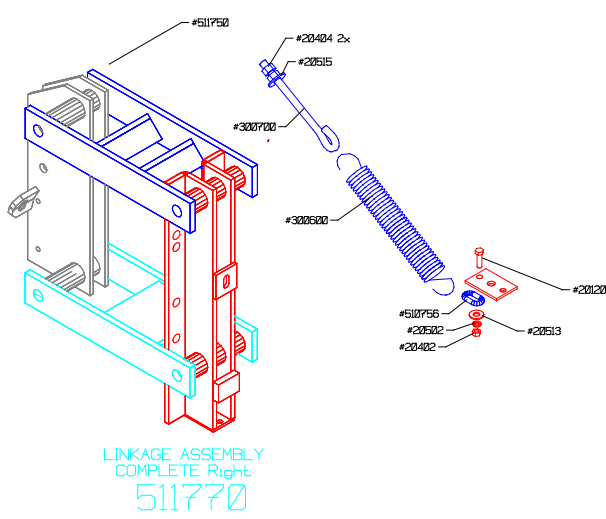

7 x 7 TRACTOR MOUNT PACKAGE

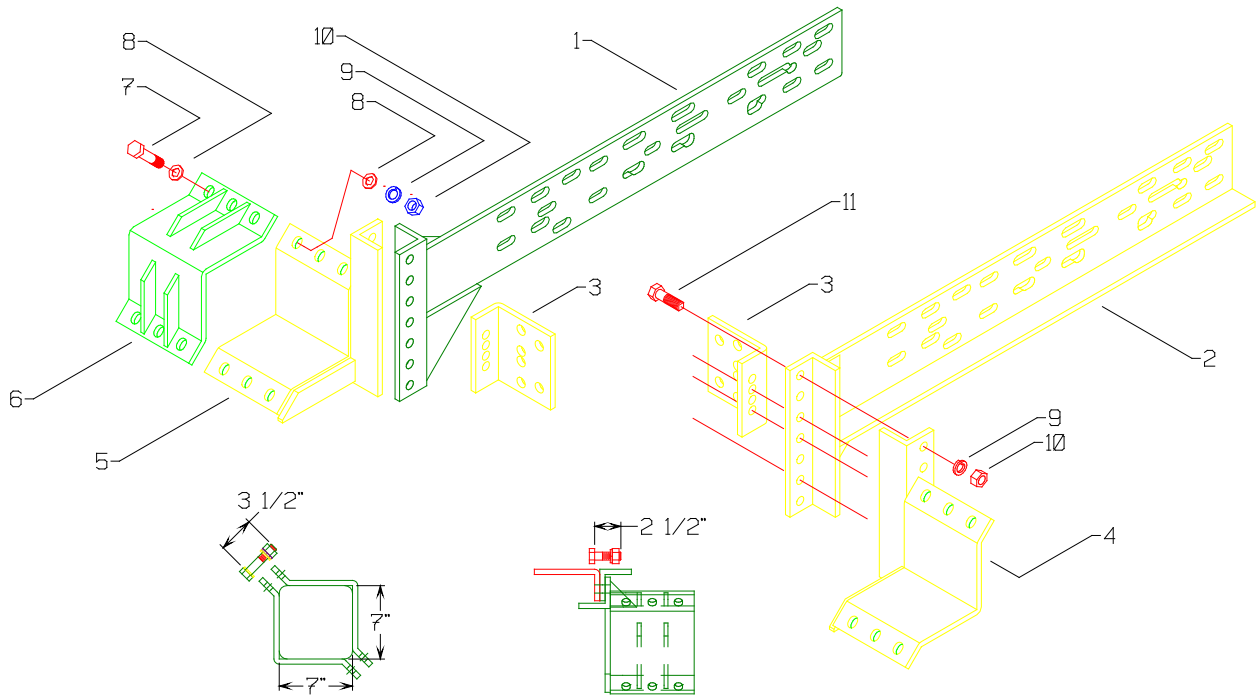

REF. PART NO.	DESCRIPTION
1	510610 Adjustable Tractor Mount Right
2	510620 Adjustable tractor Mount Left
3	510625 Front Tractor Mount
4	510640 Adjustable Toolbar Mount Left
5	510630 Adjustable Toolbar Mount Right
6	510345 Tractor Mount Backing Plate
7	020085 3/4" x 3 1/2" Bolt
8	021314 3/4" Narrow 10 Ga. Bushing
9	020507 Washer, 3/4" Lock
10	020407 Nut, 3/4"
11	020083 Bolt, 3/4" x 2 1/2"

PUSH CUTTER ACCESSORY BREAKDOWN

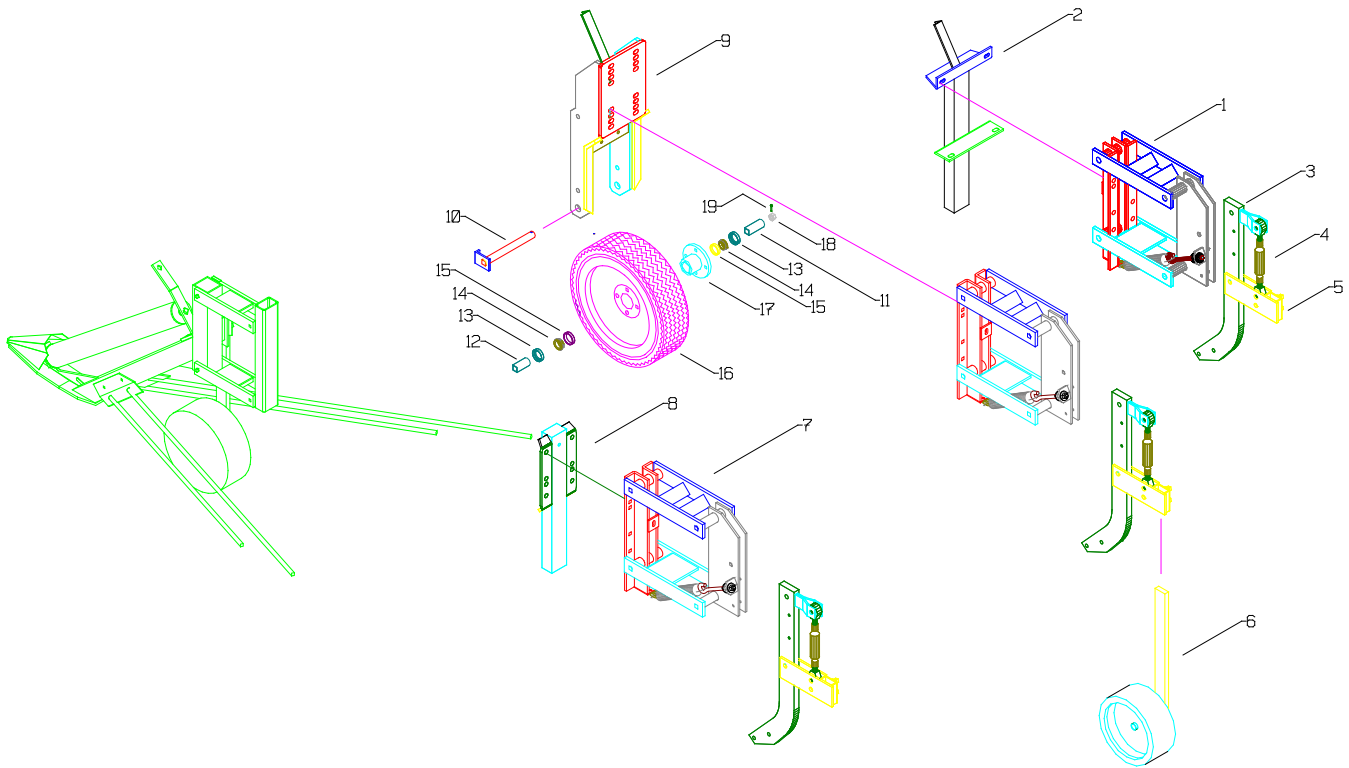

REF.	PART NO.	DESCRIPTION
1	511760	Linkage Assembly Complete Left
	511770	Linkage Assembly Complete Right
2	511720	Divider Mount Weldment (Push)
3	511700	Cutter Shank (Push Cutter)
4	021203	Turnbuckle TL199
5	511705	Gauge Wheel Mount Weldment
6	501100	Row Gauge Wheel Assembly
7	511780	Trailing Linkage Complete
	511790	Trailing Linkage Complete
8	504100	Divider Mount Tube
9	512000	Gauge Wheel Mount Weldment
10	512020	Gauge Wheel Axle Pin Weldment
11	512009	3" Wheel Spacer
12	512008	2 1/2" Wheel Spacer
13	096203	Oil Seal 471750 (1 1/4" Shaft)
14	082166	Bearing Cone L44643
15	082165	Bearing Cup LM44610
16	097042	4.80 X 12 Tire/Rim Assembly (Boat)
17	357625	Fertilizer Disc Hub W/Cup 2001
18	020151	Nut, 1" Castle 12 Thread Black
19	020832	3/16" X 2" Cotter Pin

DIVIDERS

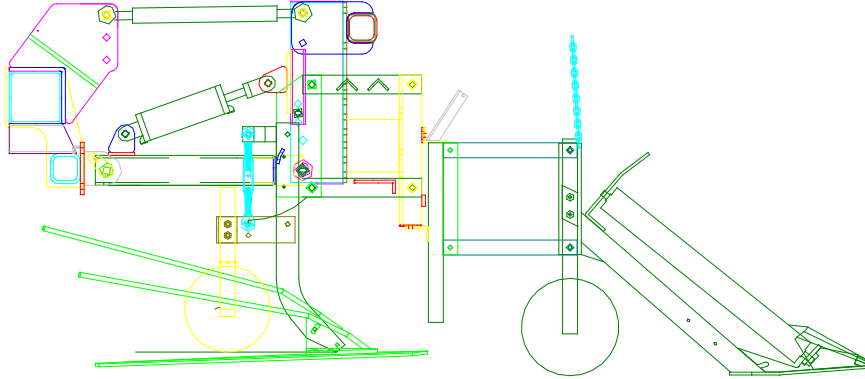

Divider Mounted With Row Linkage Ahead of Bar.

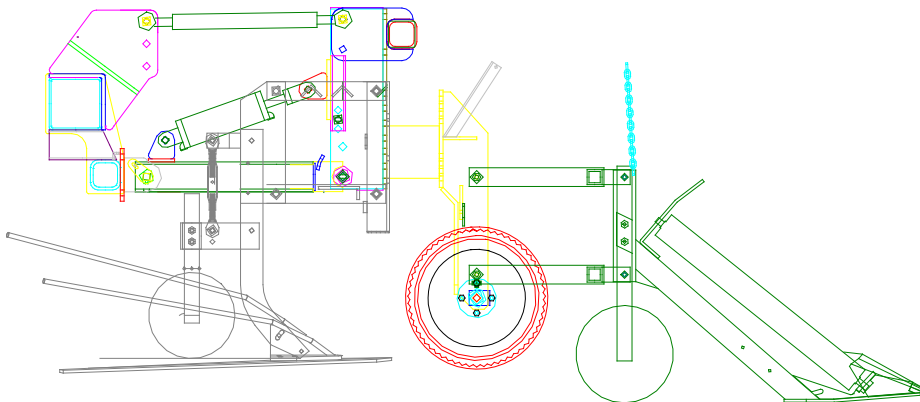

Divider Mounted With Trailing Linkage Behind Bar With Gauge Wheel in Front.

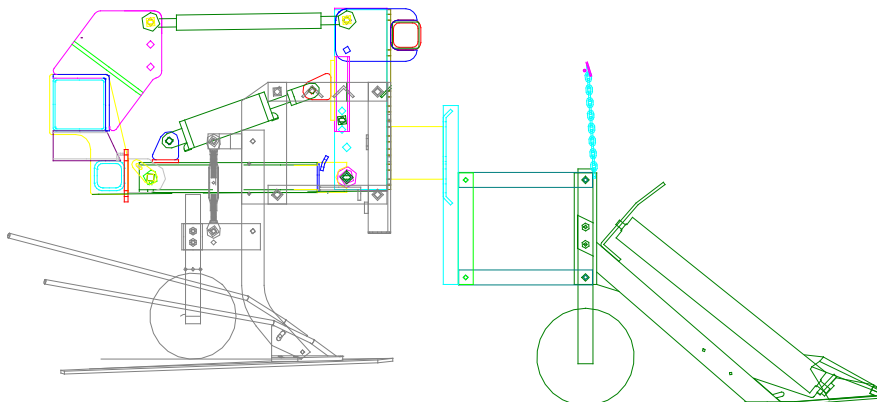

Divider Mounted With Trailing Linkage With Regular Divider Mount Tube.

Index

A	
Assembly	
Side Mount Installation.....	13
D	
Divider 1996 Assembly 1st Year Heavy	48
Divider Mountings	21
Double Rear Linkage Assemblies.....	30
F	
Front Divider Lift.....	18
Front Lift Previous To 1995.....	51
G	
Gauge Wheel Assembly	42
H	
HD 1998 Bar Mount Assemblies.....	22
HD 1998 Divider Tractor Mount Dividers	24
Hydraulic Schematic	44
K	
Knife Shanks & Gauge Wheels	28
L	
Linkage Assemblies	26
M	
Mid Mount & Toolbar.....	19
Mid Mount Assembly.....	14, 20
O	
Operating And Service	
Divider Gauge Wheels	11
Divider Rod Adjustment	11
Lubrication	11
Parallel Linkage	11
Row Divider Setting Adjustment	11

Operation And Service	
Blade /Gauge Wheel Settings	10
Divider Rollers	11
Midmount Adjustment	10

P

Push Cutter	
Accessory Breakdown.....	64
Dividers	65
Mounting Linkage	60
Row Linkage Breakdown	61
Row Linkages Complete	62
Tractor Mount Package.....	63

R

Rear Mount Assemblies	32
Rear Mount Assembly.....	16
Row Divider Assembly (Original Style)	46

S

Safety	4
Decals	8
General.....	5
Hydraulic	7
Maintenance.....	6
Operating.....	6
Tire	8
Transport.....	7
Sign Off Form	9
Stealth Assembly 1997	49
Stealth Assembly 1997 Long	50
Stealth Divider Cutting Unit Long.....	40
Stealth Divider Cutting Unit Short	38
Stealth Troubleshooting	35
Stealth Unit Tool Bar Assemblies.....	36

T

Table of Contents	3
Tractor Mounting Configurations.....	52
Tractor Mounts	33
Troubleshooting	12

Harriston

INDUSTRIES, INC.

Box 378, Minto, ND 58261
(800)437-8205 (701)248-3286
Fax: (701)248-3070

PRINTED IN USA

ISSUE DATE: JANUARY 2002